

Lavorazioni

**tierre 550TH**

*Processing*



tierre 550TH

Scala 1:1

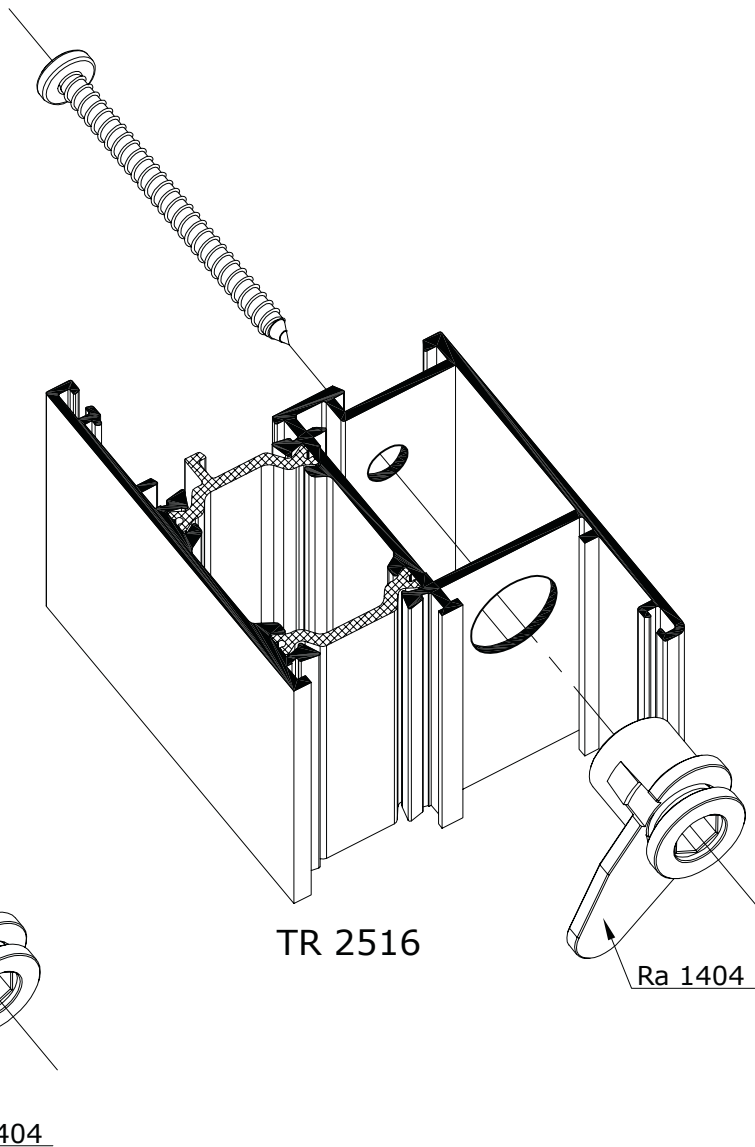
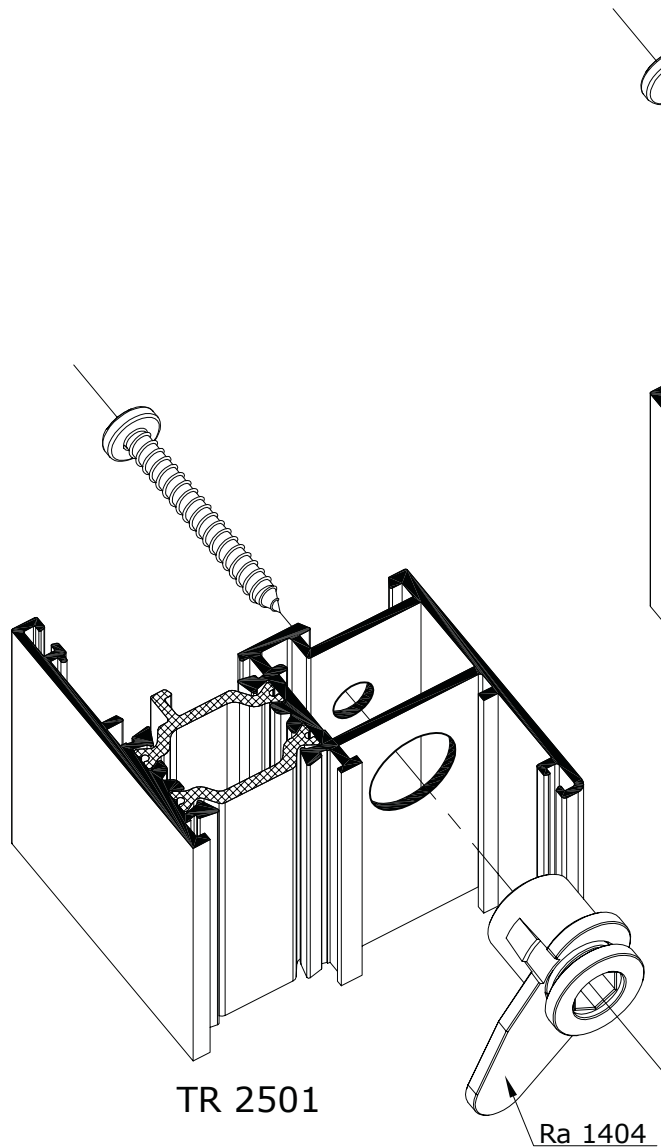
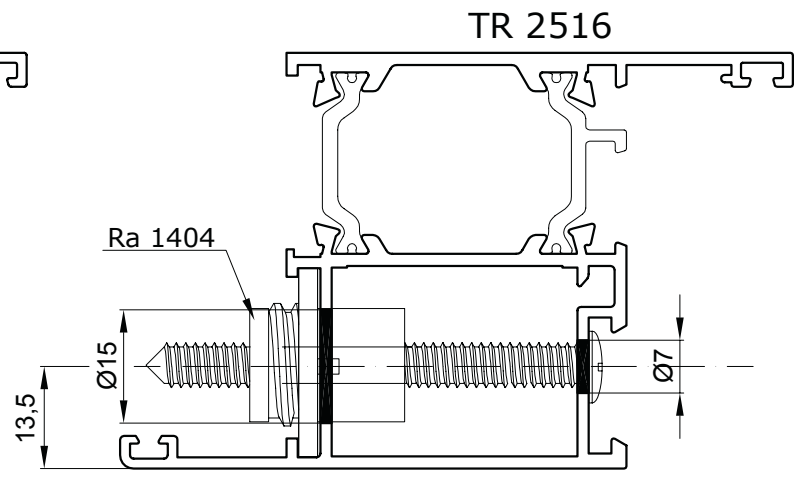
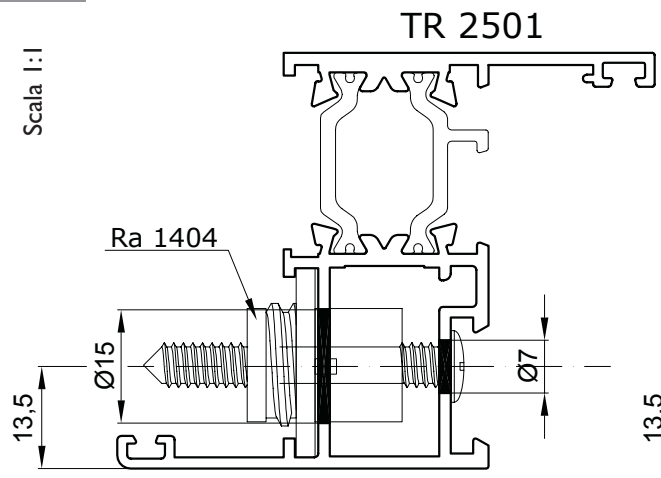

Scarico acqua sul telaio  
- apertura interna -

tierre 550TH

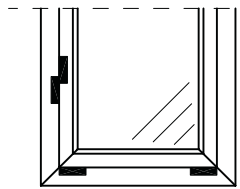
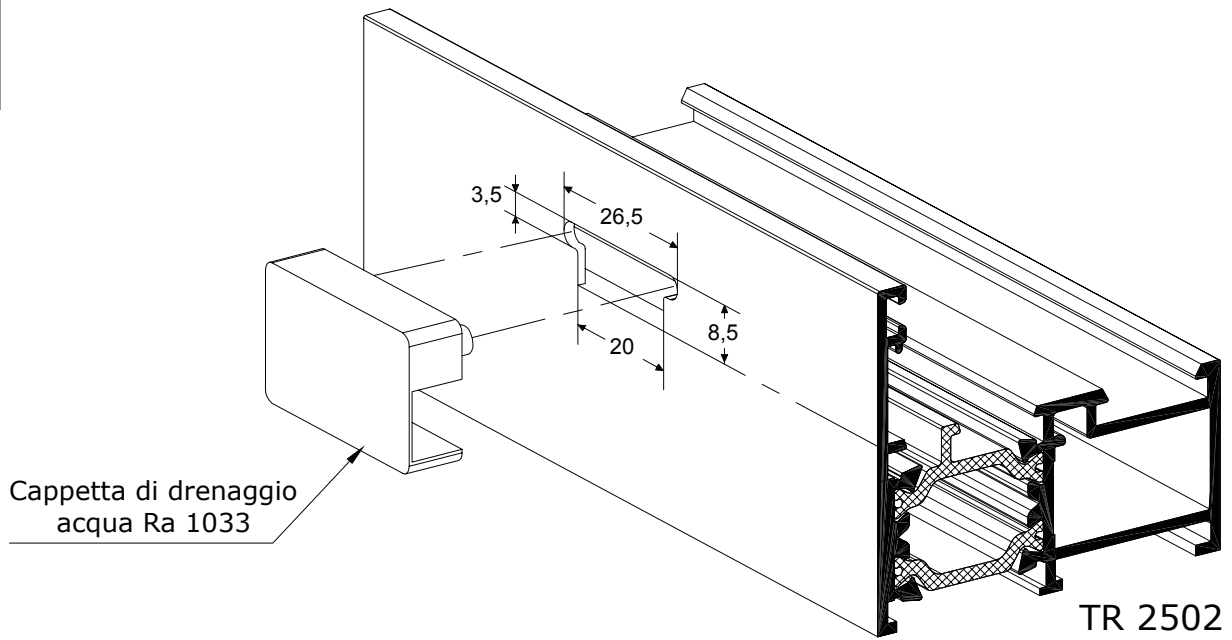

Per telai ad 1 ante  
minimo 2 asole

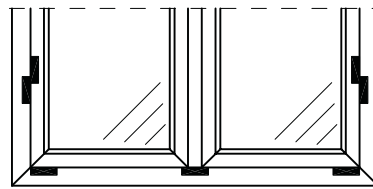

Per telai a 2 ante  
minimo 3 asole

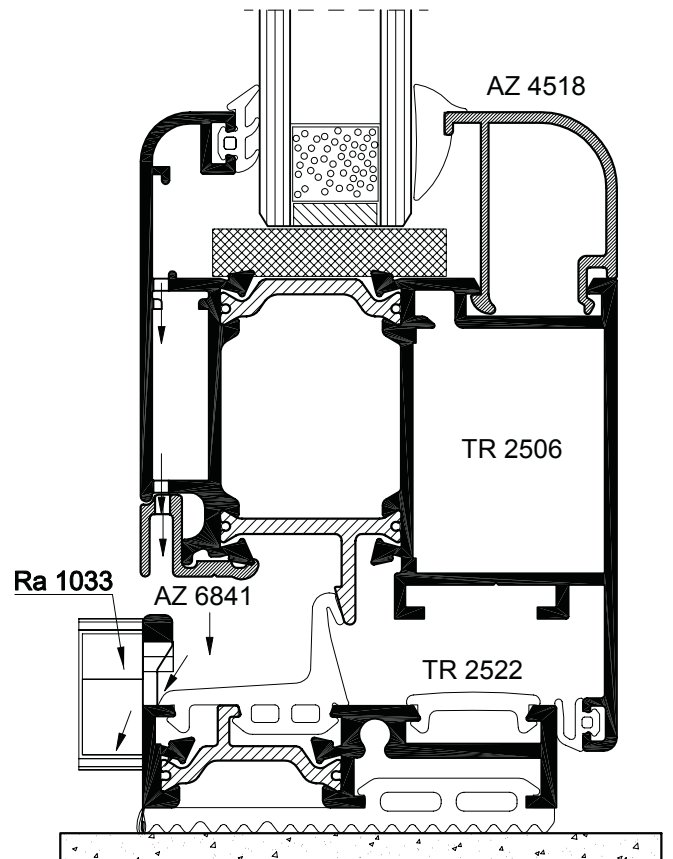
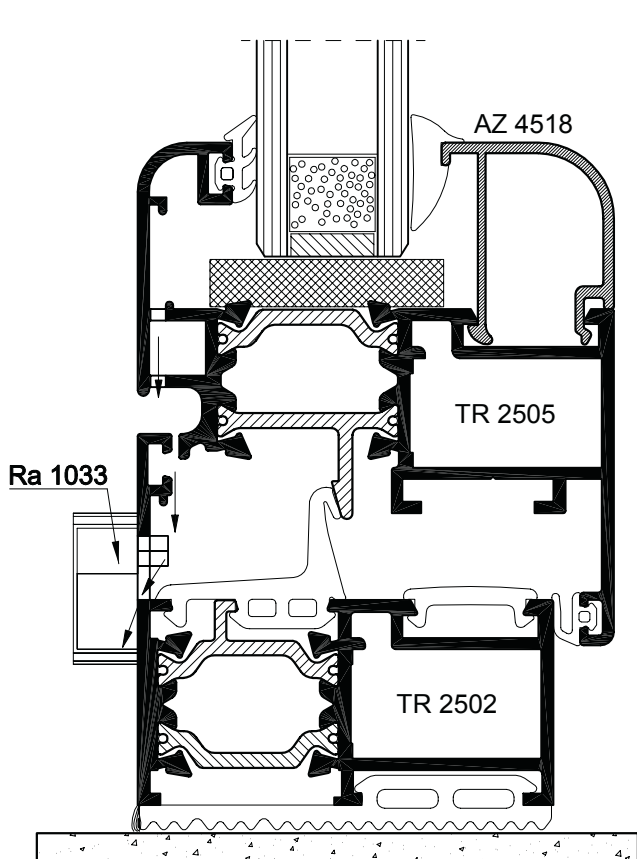

Scarico acqua sul telaio  
- apertura esterna -

tierre 550TH

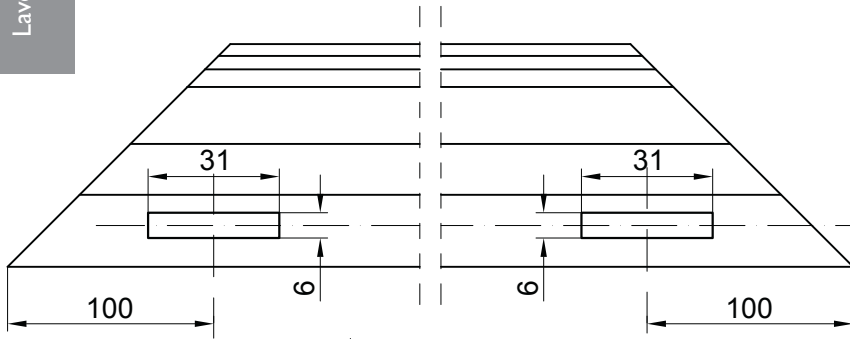

TR 2504

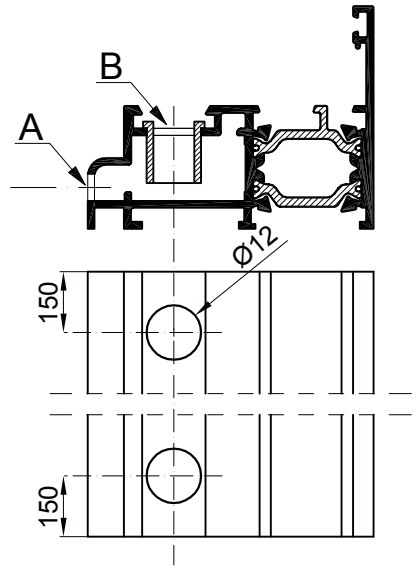
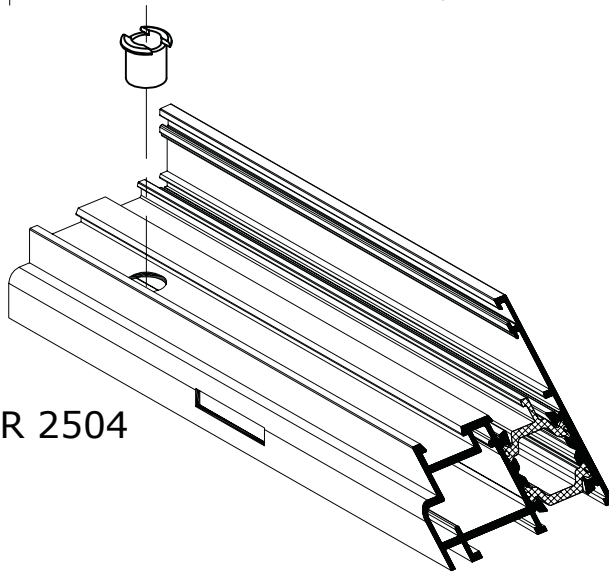

- (A) Asola 31x6: n° 2
- (B) Foro Ø12: n° 2 per inserimento boccola Ra 2601

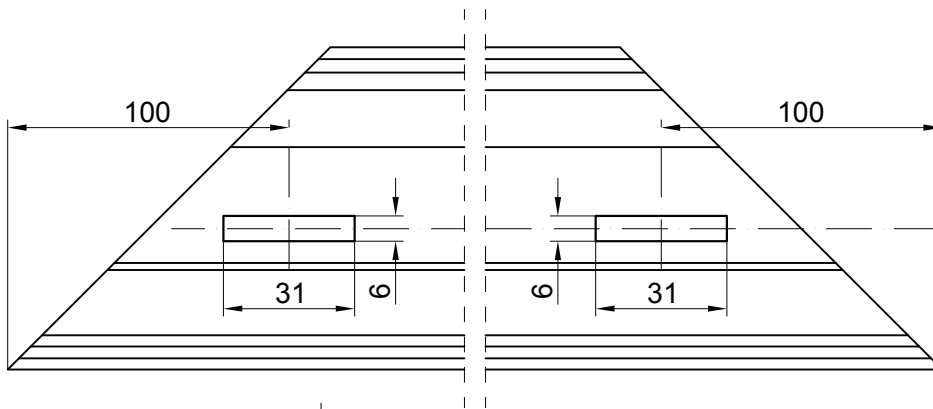
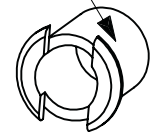

TR 2519

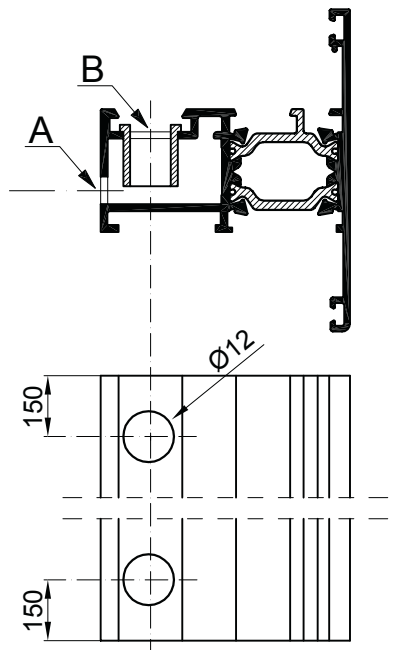
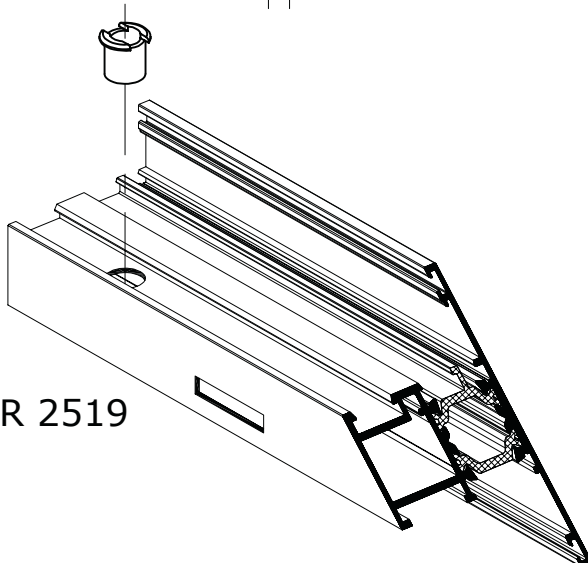

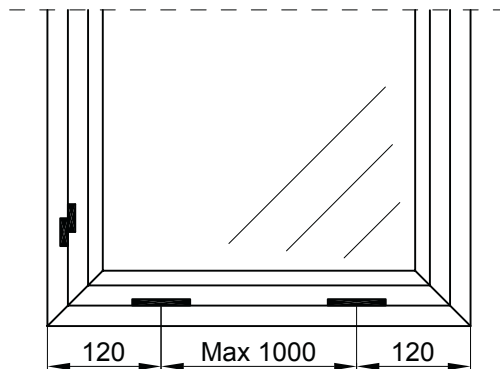
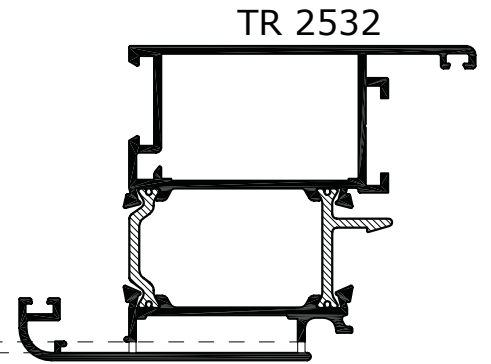
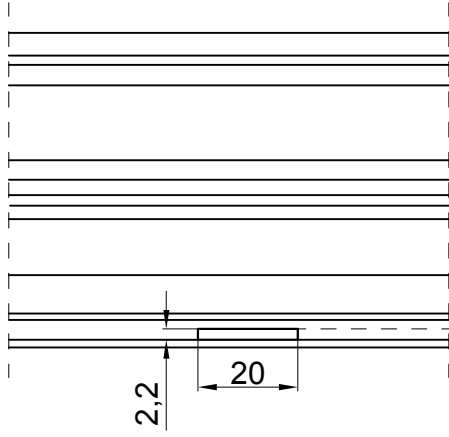
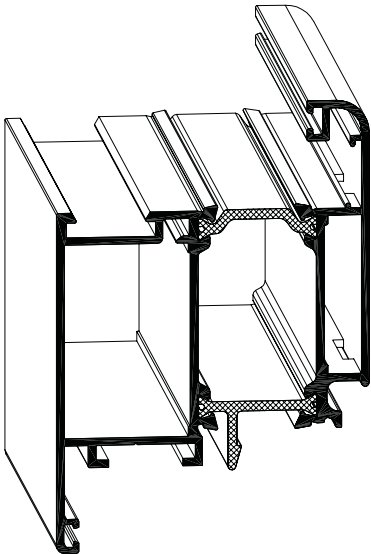
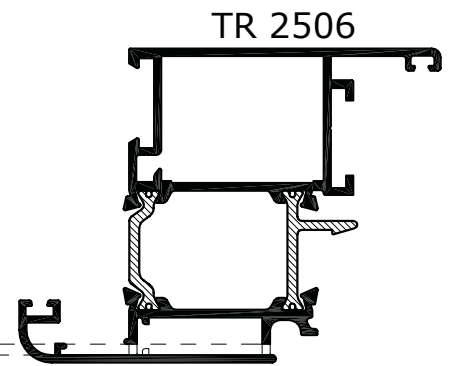
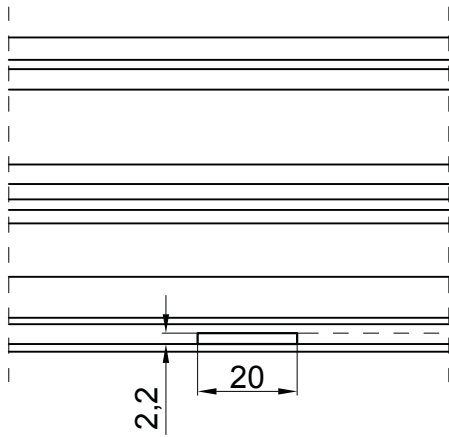
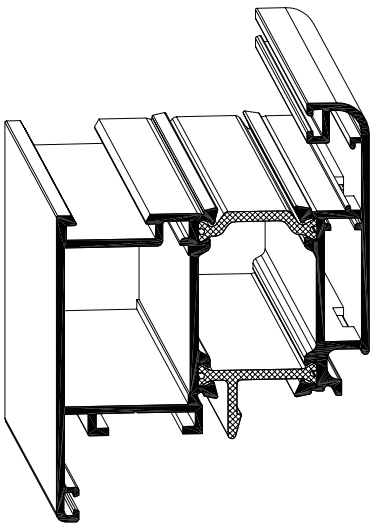
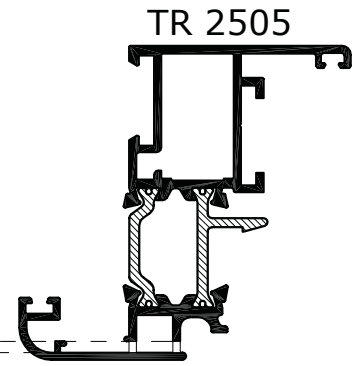
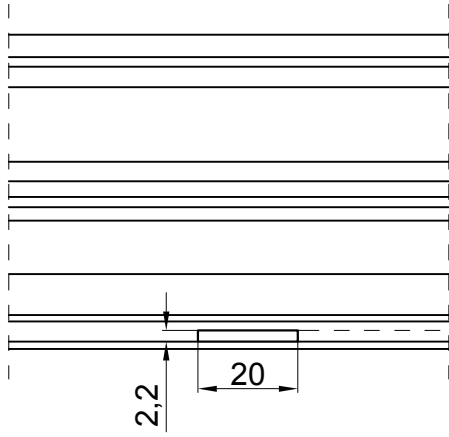
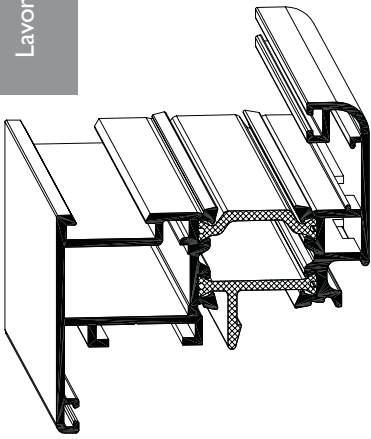

N.B.: - Lavorazione eseguita con punzonatrice Ra 3800

### Squadretta a spinare Ra 1705

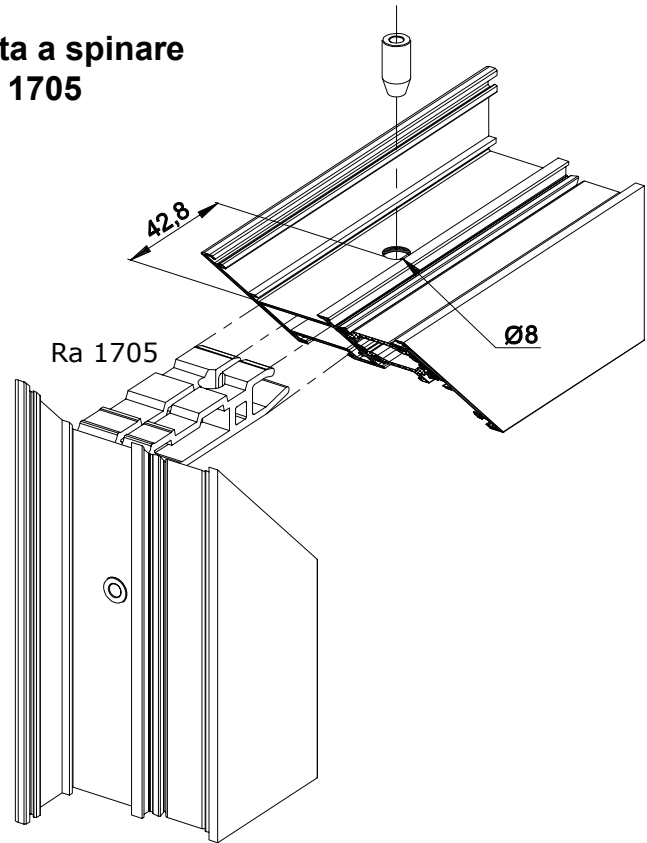
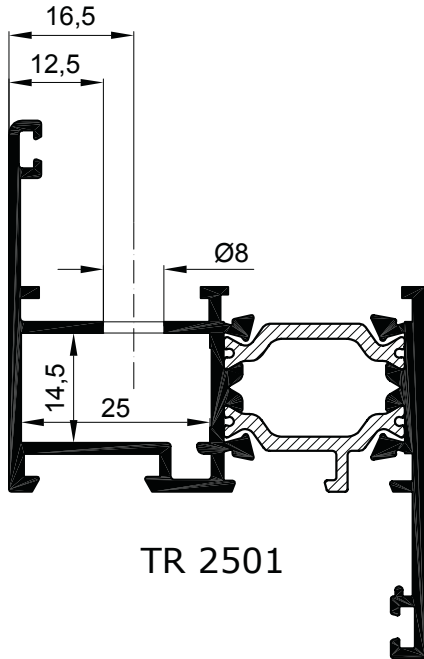

N.B.: - Per l'unione degli angoli si consiglia l'utilizzo del collante  
- Lavorazione eseguita con punzonatrice Ra 3800

### Squadretta a spinare Ra 1705

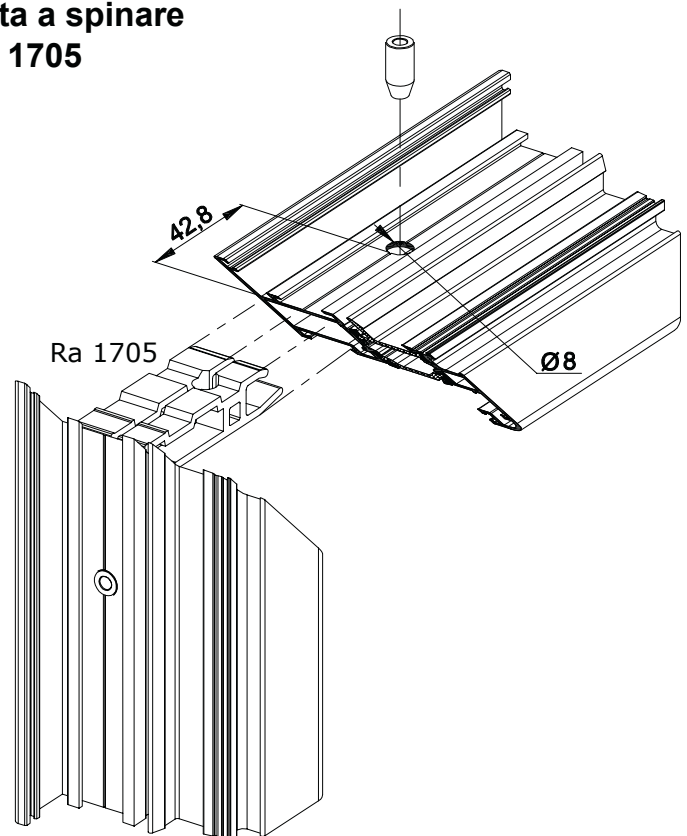
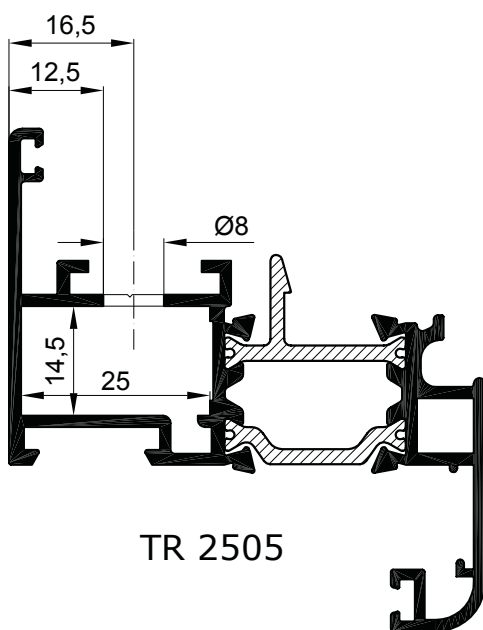

N.B.: - Per l'unione degli angoli si consiglia l'utilizzo del collante  
- Lavorazione eseguita con punzonatrice Ra 3800

### Squadretta a tiraggio meccanico Ra 3813

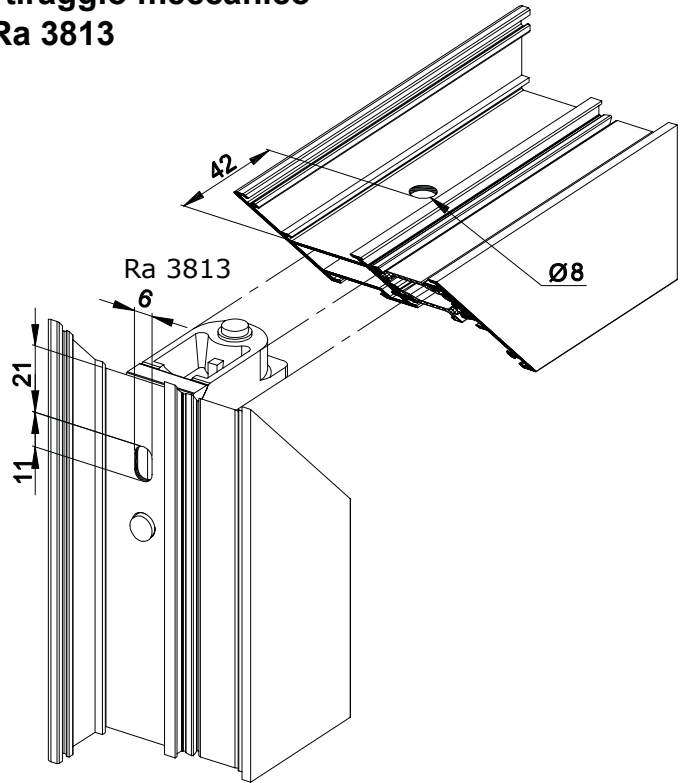
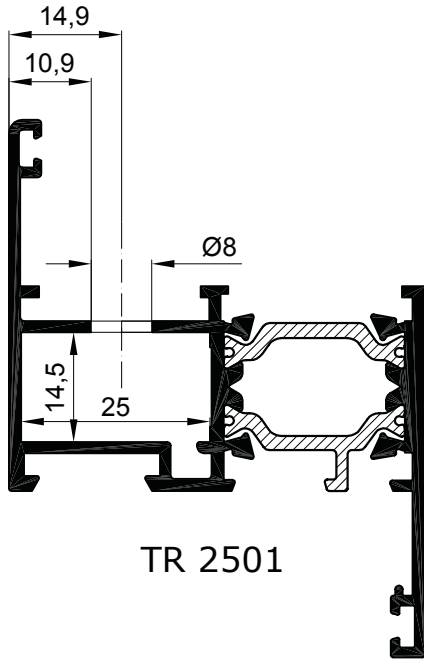

N.B.: - Per l'unione degli angoli si consiglia l'utilizzo del collante  
- Lavorazione eseguita con punzonatrice Ra 3800

### Squadretta a tiraggio meccanico Ra 3813

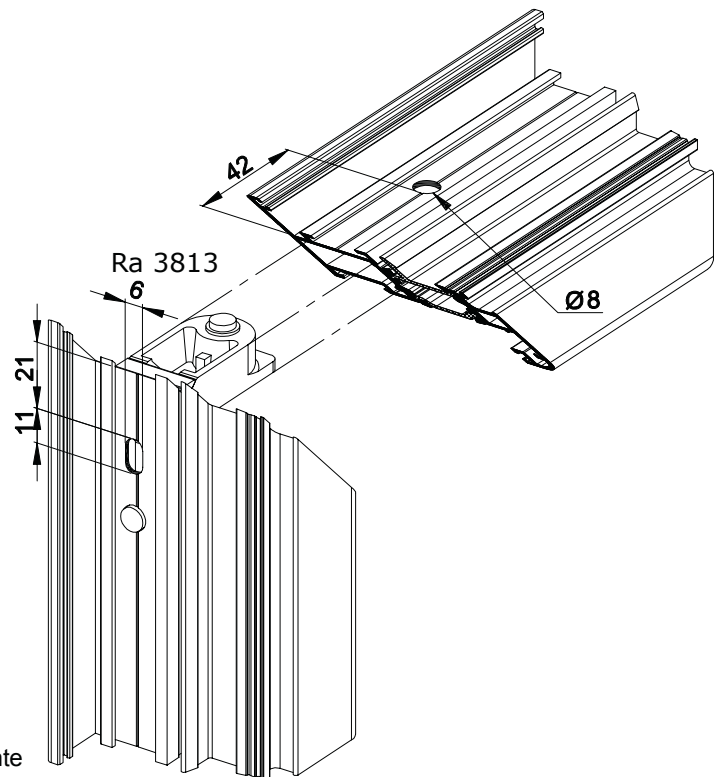
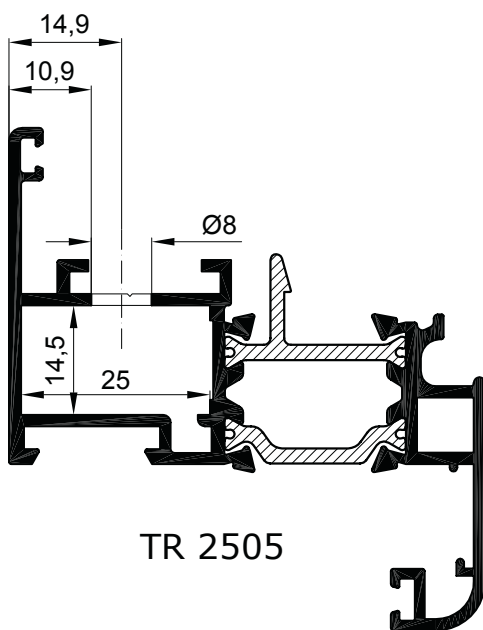

N.B.: - Per l'unione degli angoli si consiglia l'utilizzo del collante  
- Lavorazione eseguita con punzonatrice Ra 3800

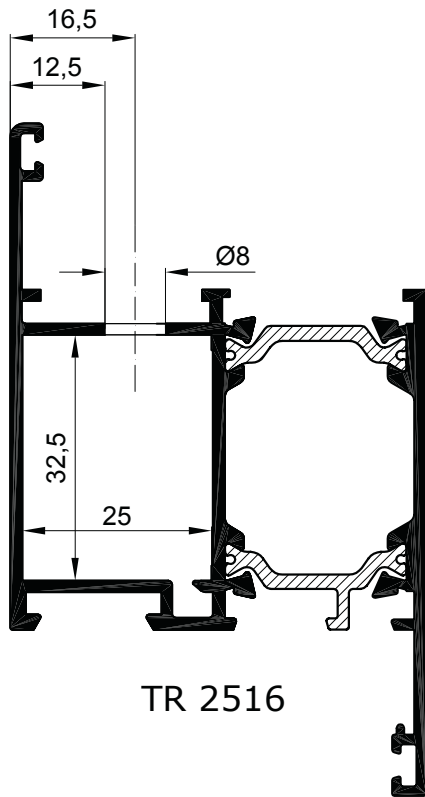

Squadretta a spinare  
Ra 1707

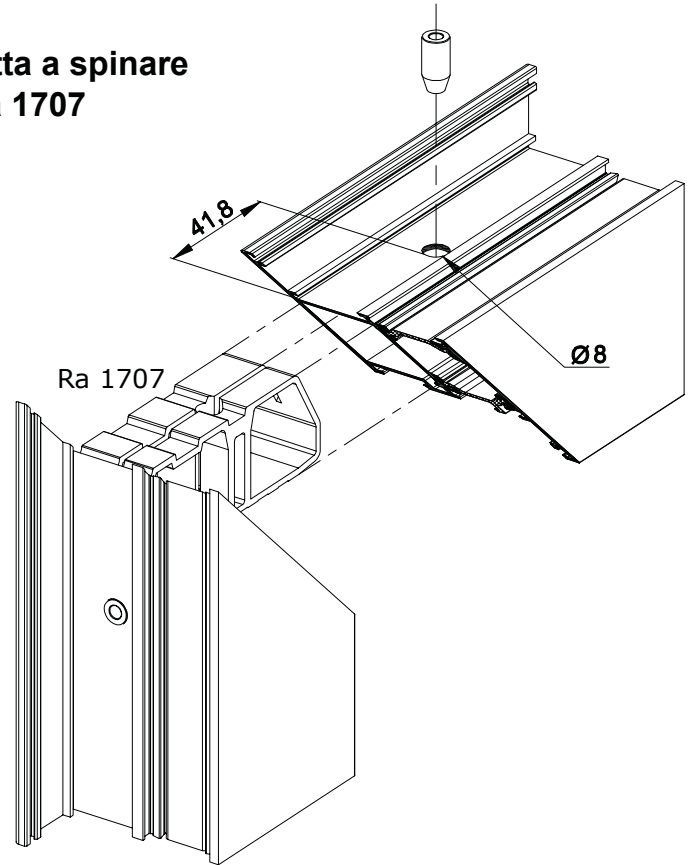

N.B.: - Per l'unione degli angoli si consiglia l'utilizzo del collante  
- Lavorazione eseguita con punzonatrice Ra 3800

Squadretta a spinare  
Ra 1707

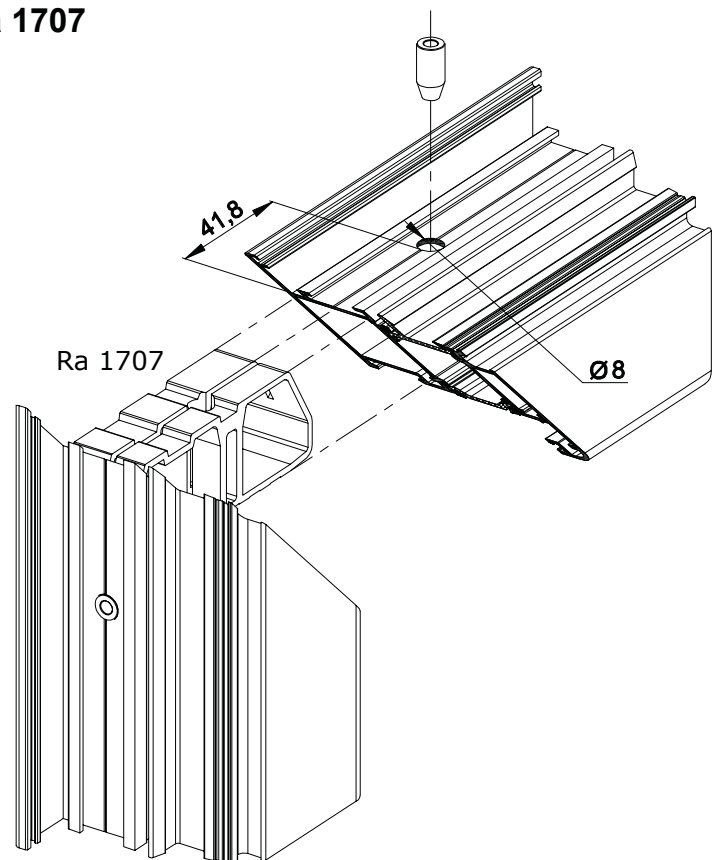
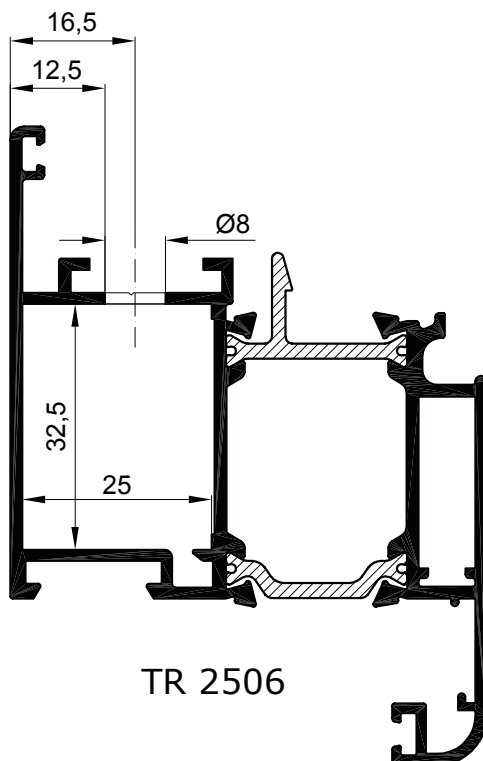

N.B.: - Per l'unione degli angoli si consiglia l'utilizzo del collante  
- Lavorazione eseguita con punzonatrice Ra 3800



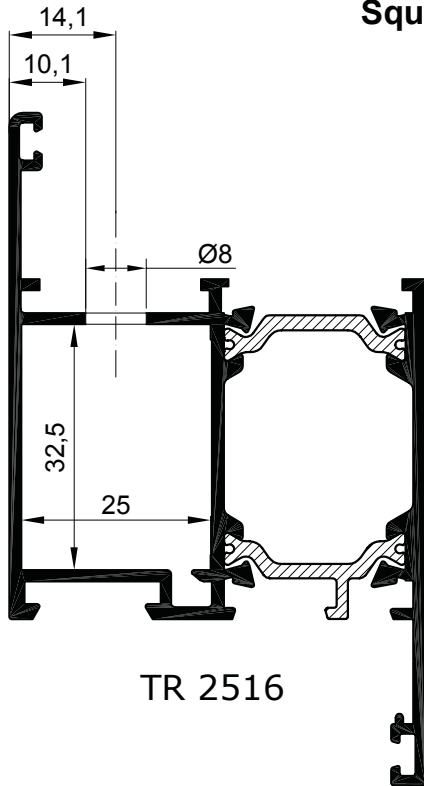

Squadretta a tiraggio meccanico  
Ra 3817

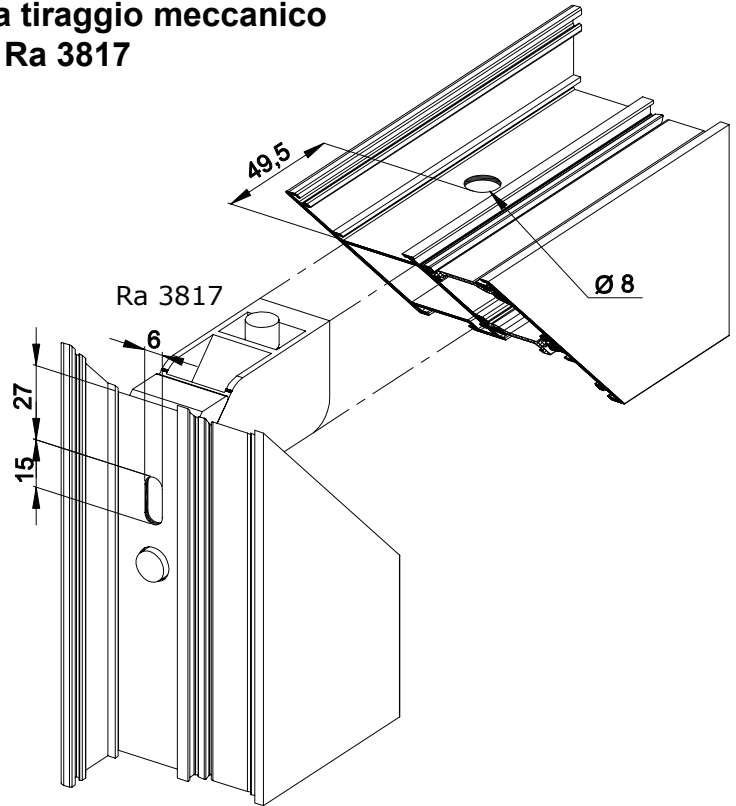

N.B.: - Per l'unione degli angoli si consiglia l'utilizzo del collante  
- Lavorazione eseguita con punzonatrice Ra 3800

Squadretta a tiraggio meccanico  
Ra 3817

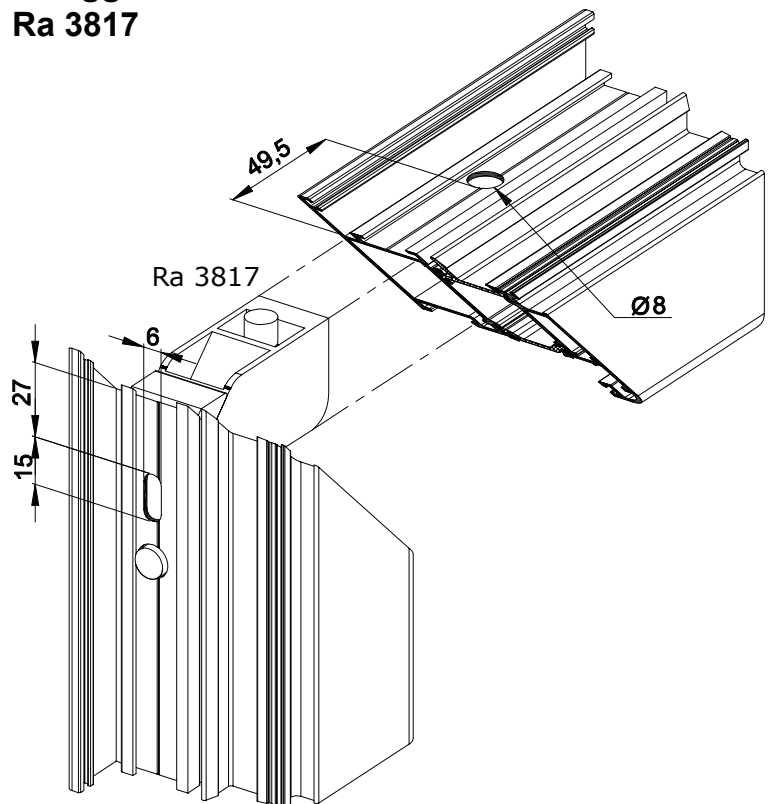
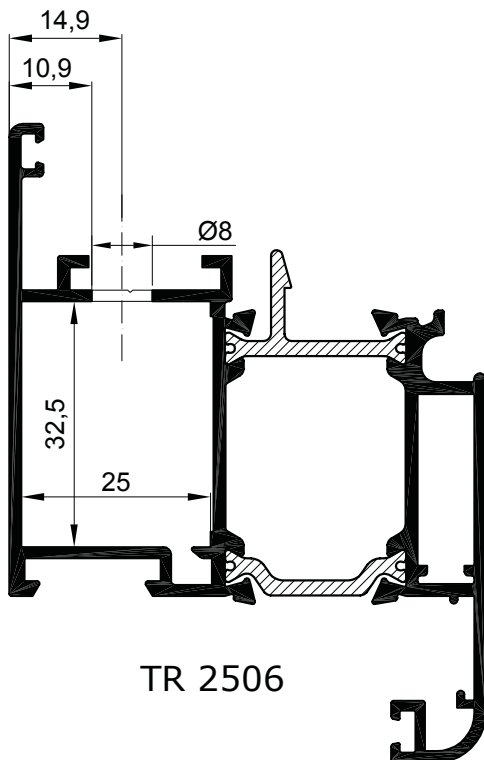

N.B.: - Per l'unione degli angoli si consiglia l'utilizzo del collante  
- Lavorazione eseguita con punzonatrice Ra 3800

**Squadretta a spinare  
Ra 1714**

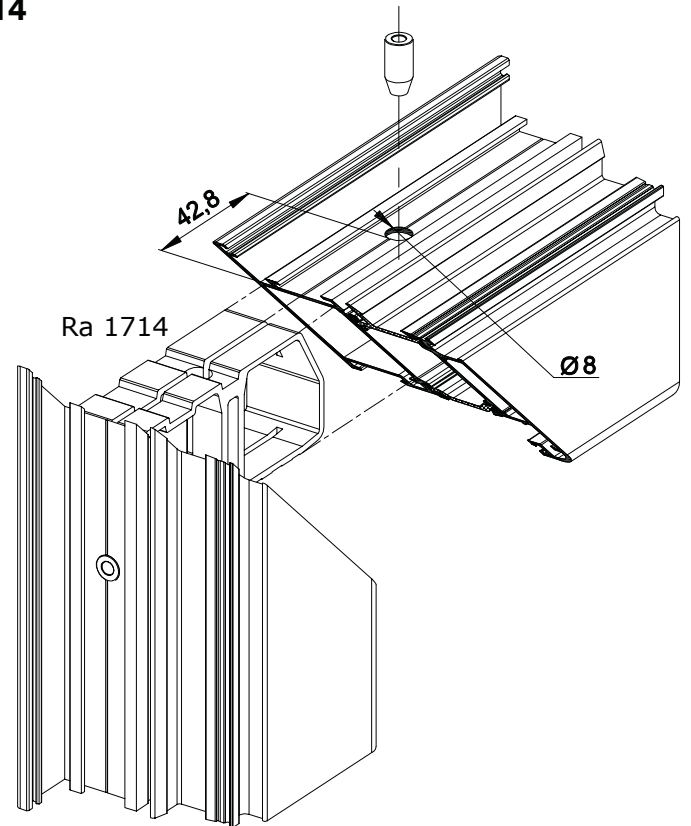
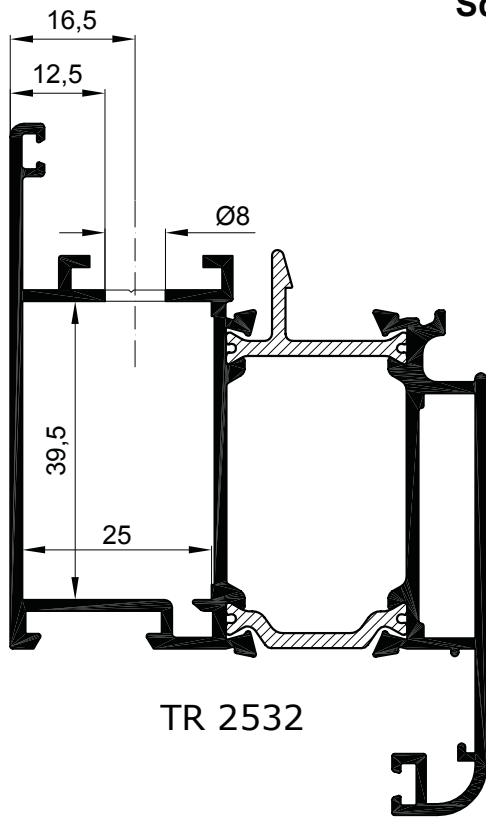

N.B.: - Per l'unione degli angoli si consiglia l'utilizzo del collante  
- Lavorazione eseguita con punzonatrice Ra 3800

**Squadretta di allineamento e tenuta  
Ra 3804**

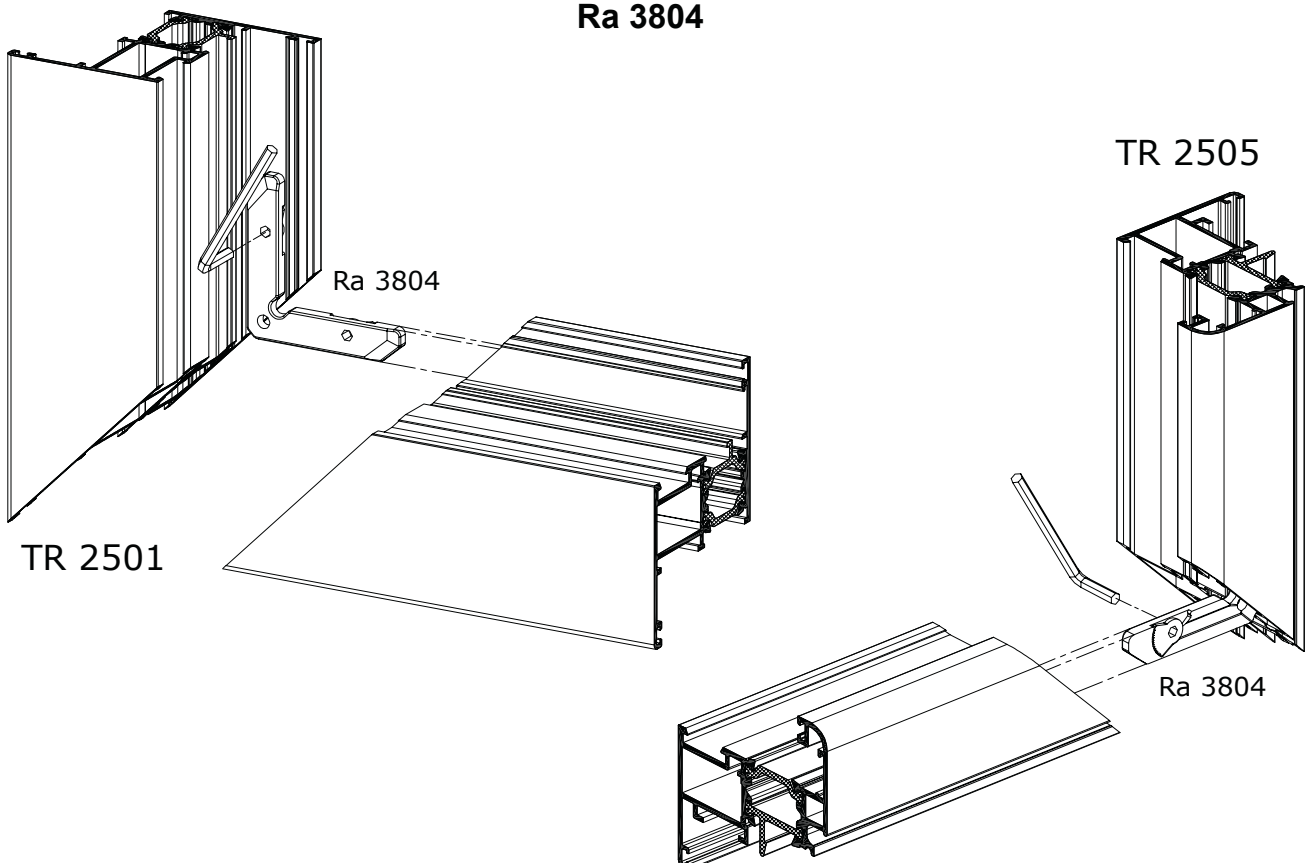

### Squadretta a cianfrinare Ra 3805

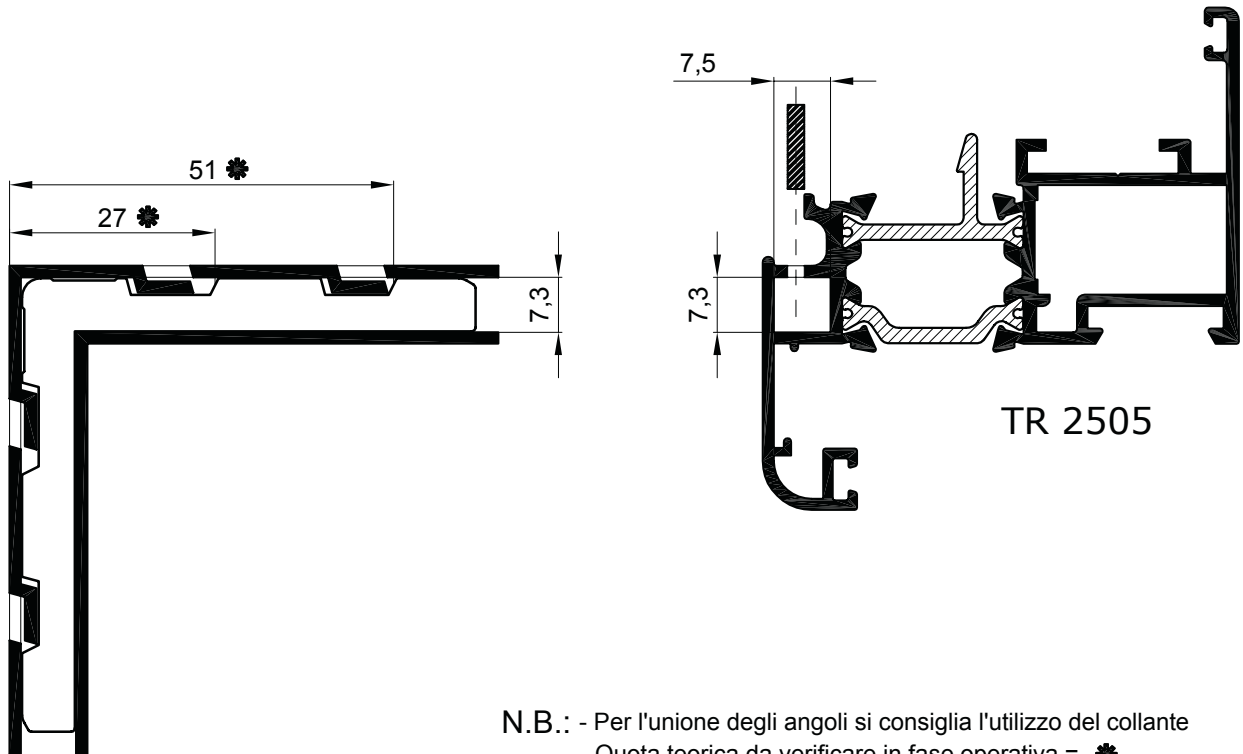

N.B.: - Per l'unione degli angoli si consiglia l'utilizzo del collante  
- Quota teorica da verificare in fase operativa = \*

### Squadretta a cianfrinare Ra 3806

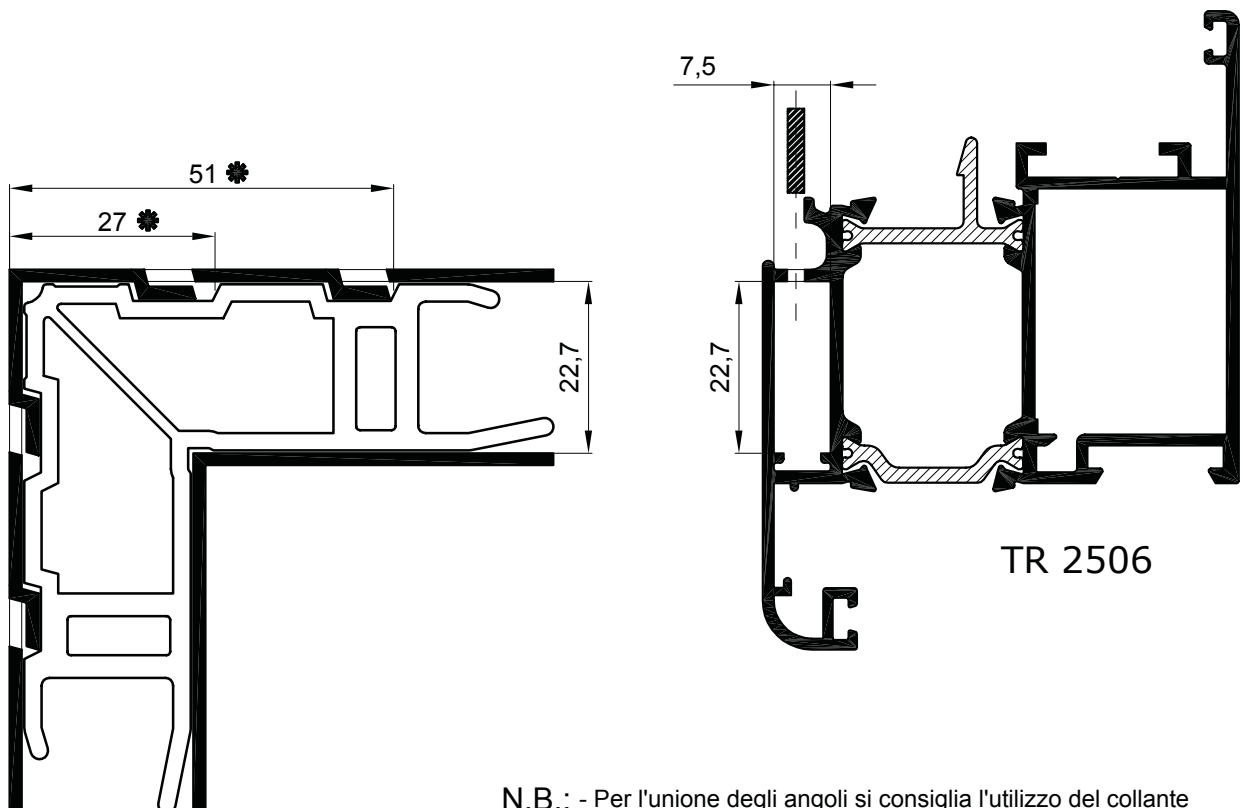

N.B.: - Per l'unione degli angoli si consiglia l'utilizzo del collante  
- Quota teorica da verificare in fase operativa = \*

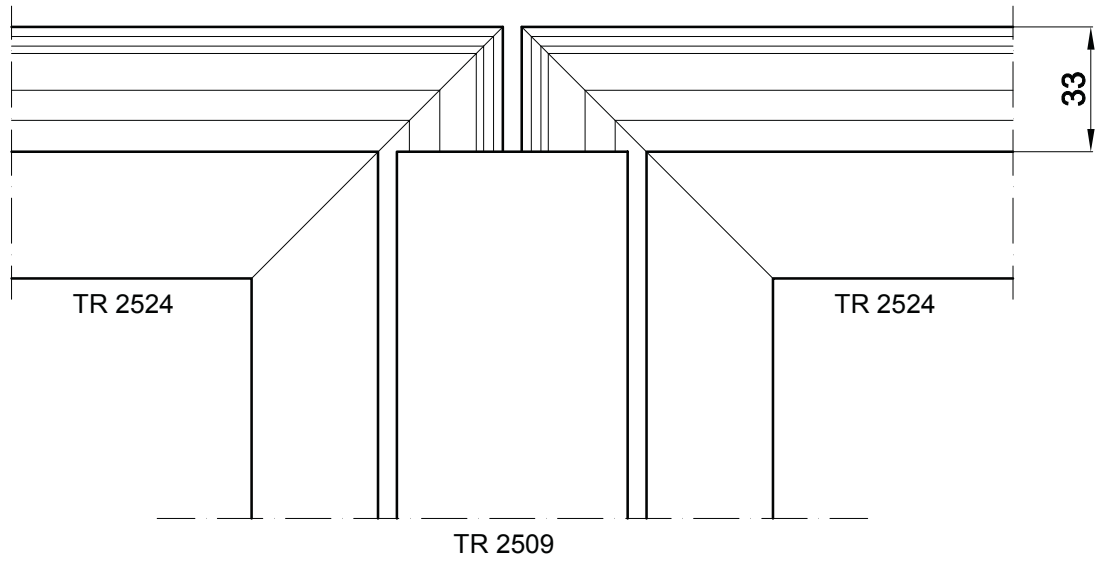

**APPLICAZIONE  
TAPPI DI TENUTA**

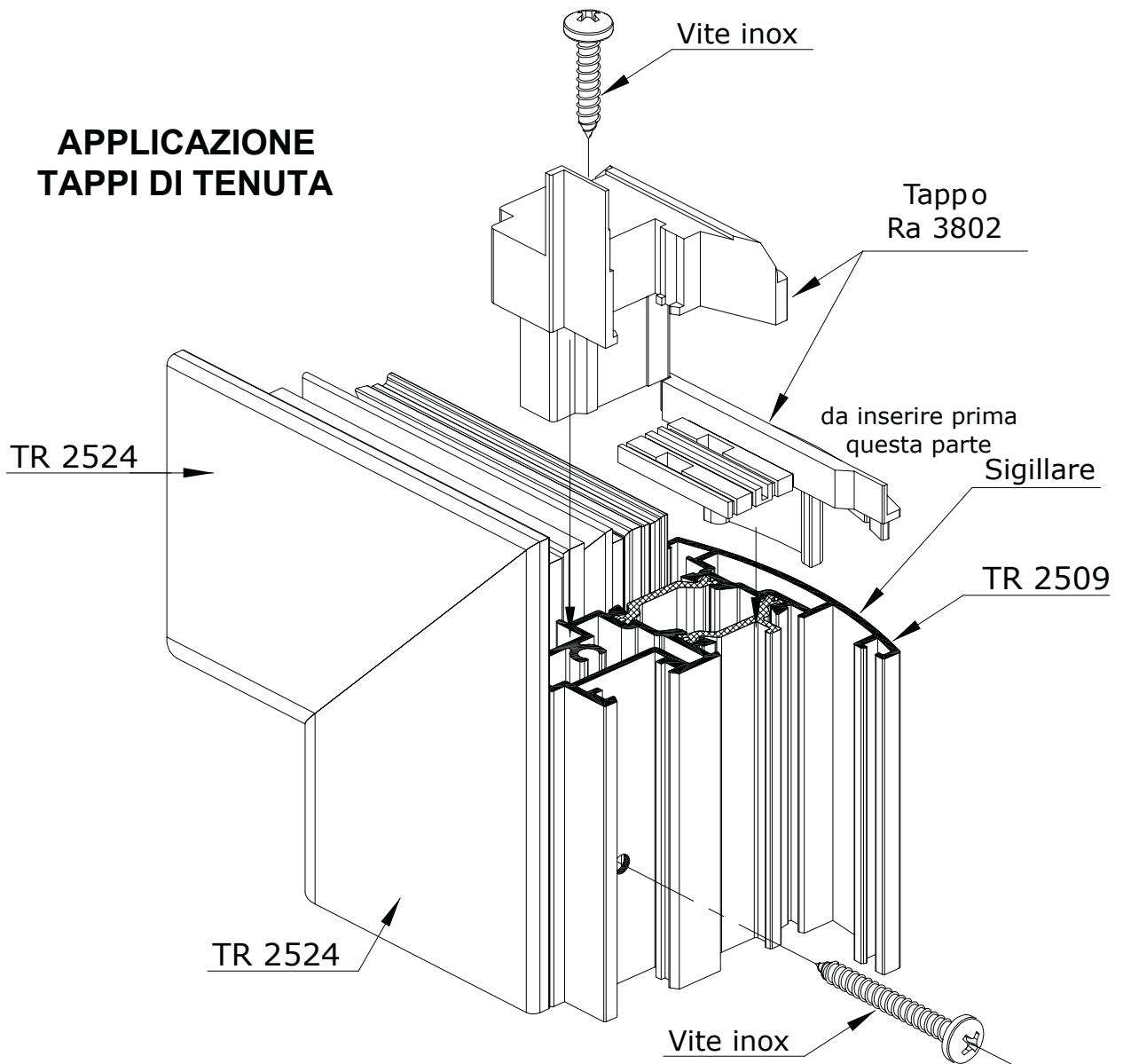

N.B.: - Per evitare lo sfilaggio e garantire la tenuta i tappi devono essere avvitati sul riscontro centrale

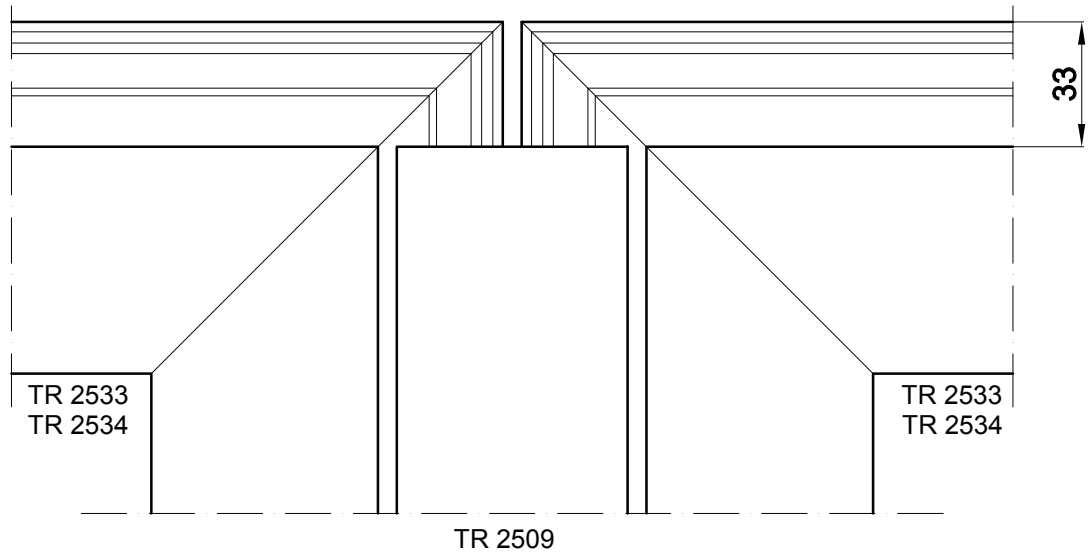

**APPLICAZIONE  
TAPPI DI TENUTA**

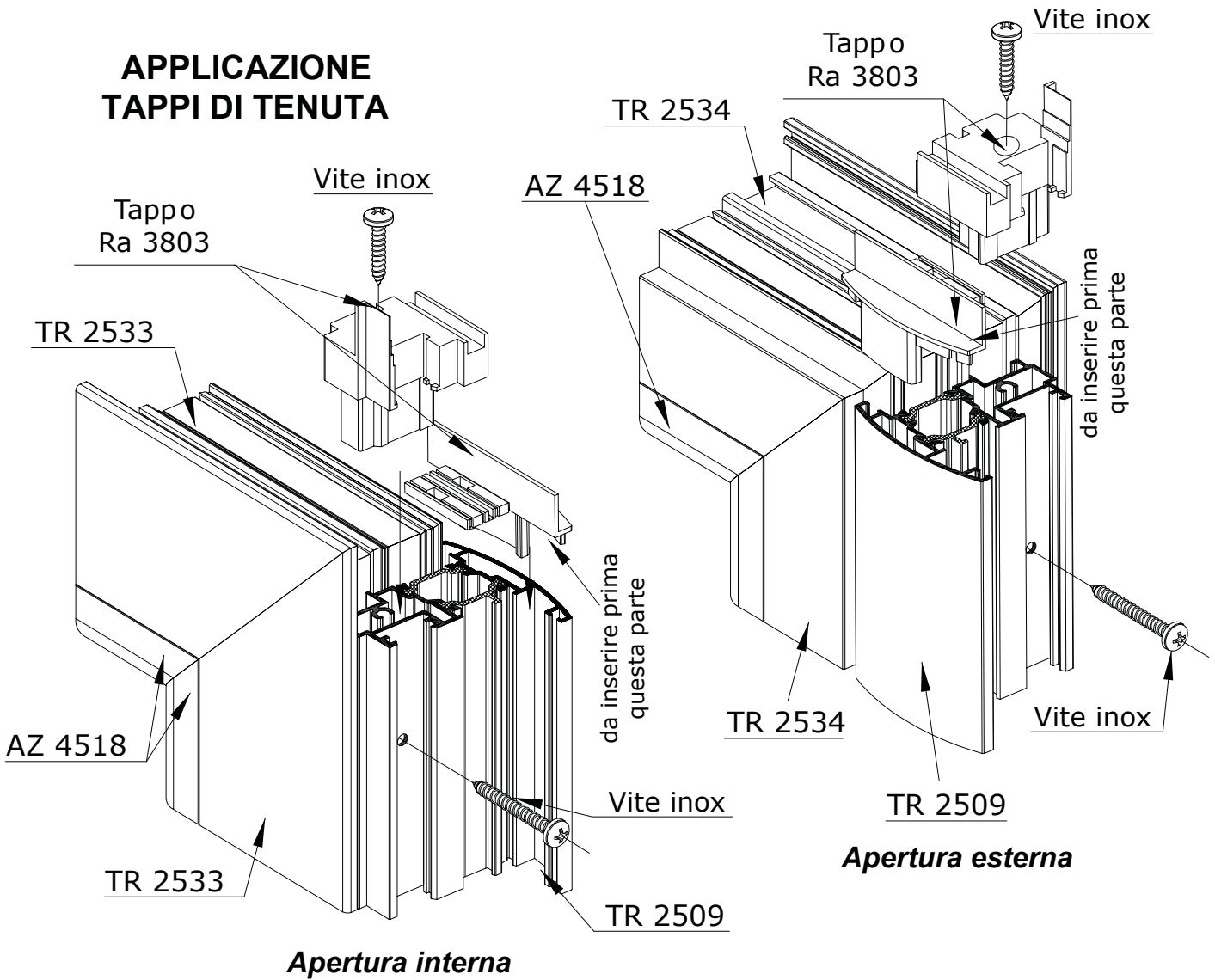

N.B.: - Per evitare lo sfilaggio e garantire la tenuta i tappi devono essere avvitati sul riscontro centrale

ANTE

FERMAVETRI DRITTI

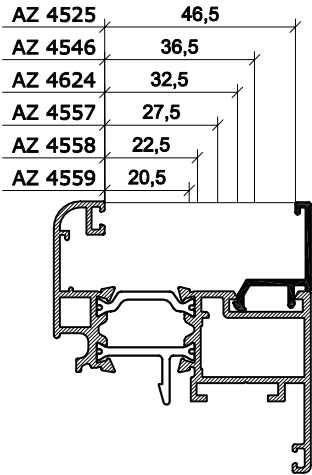

FERMAVETRI ARROTONDATI

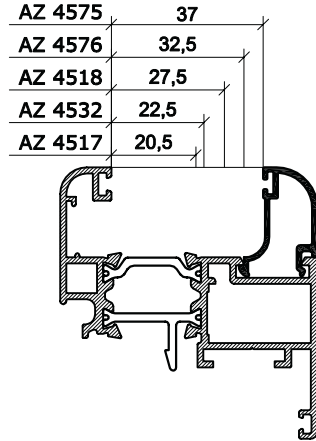

FERMAVETRI ARROTONDATI CON MOLLETTA

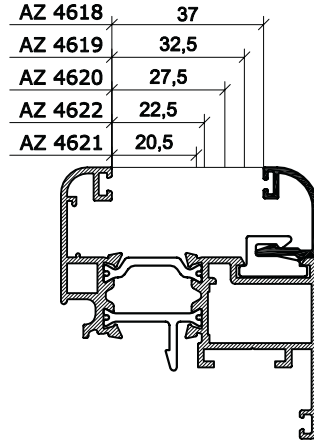

FERMAVETRI SCORNICIATI

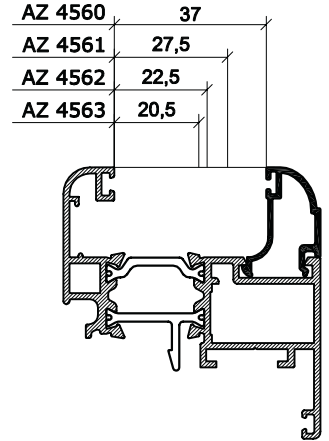

TELAI

FERMAVETRI DRITTI

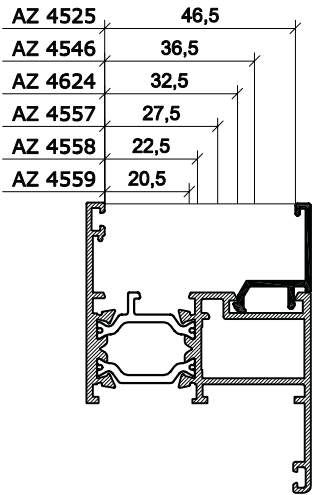

FERMAVETRI ARROTONDATI

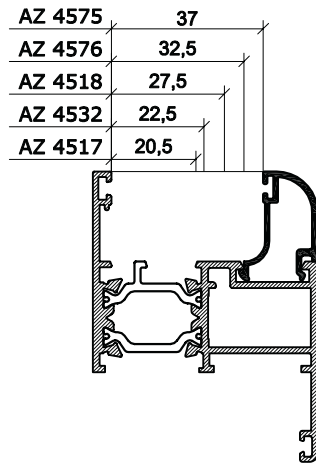

FERMAVETRI ARROTONDATI CON MOLLETTA

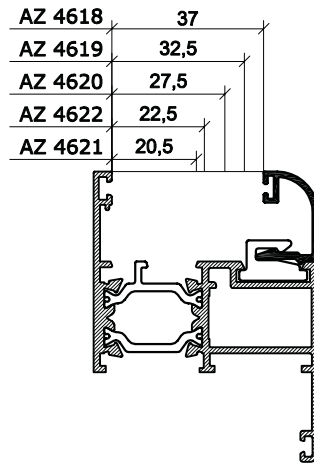

FERMAVETRI SCORNICIATI



TABELLA GUARNIZIONI  
(QUOTE CON GUARNIZIONI IN OPERA)

Rg 307 2 mm	Rg 320 3 mm	Rg 308 4 mm	Rg 321 5 mm	Rg 309 6 mm	Rg 350 2,5 mm	Rg 351 3,5 mm	Rg 360 5 mm

SPESSORAMENTO VETRI

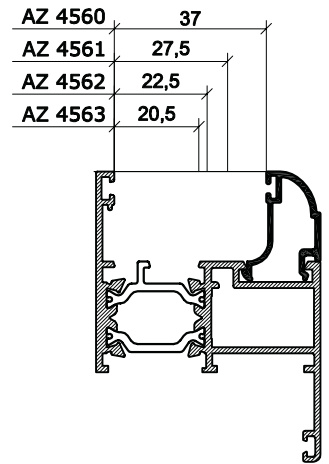
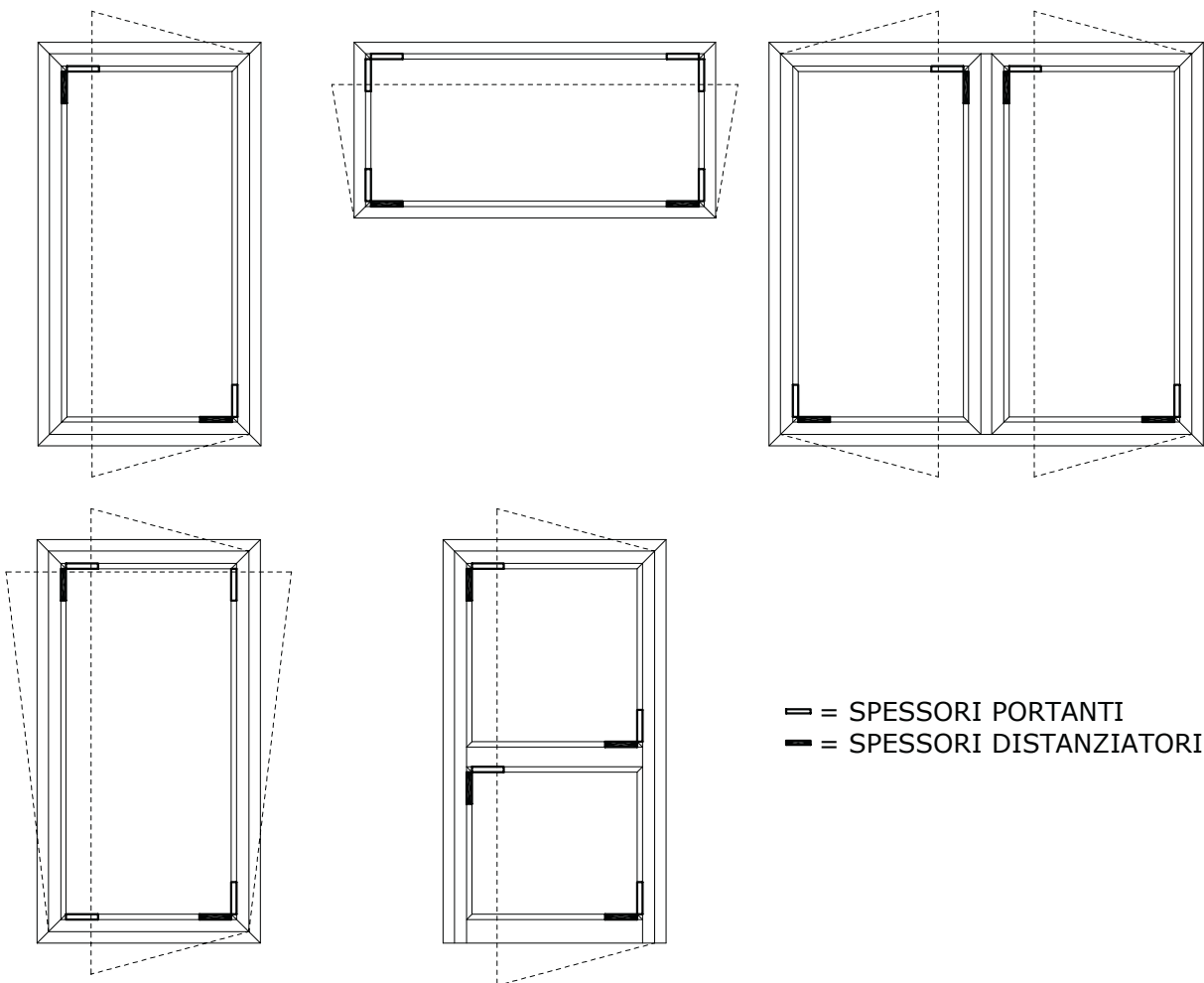

FISSAGGIO A MURO

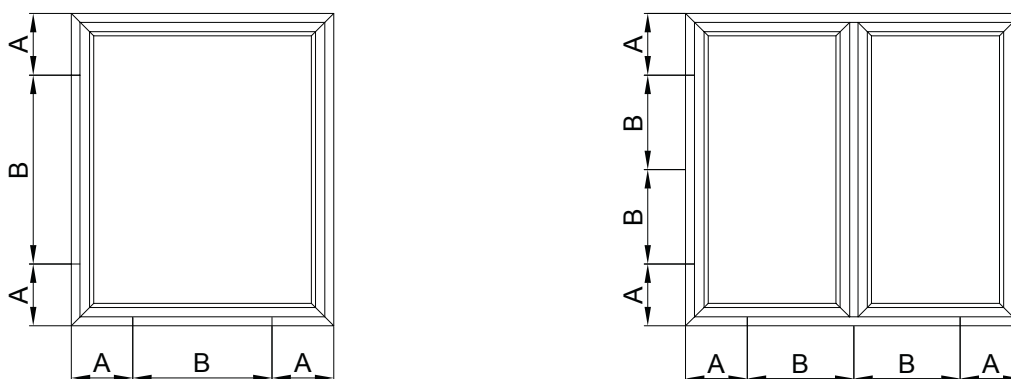

A = 100 ÷ 150 mm  
 B = massimo 500 mm

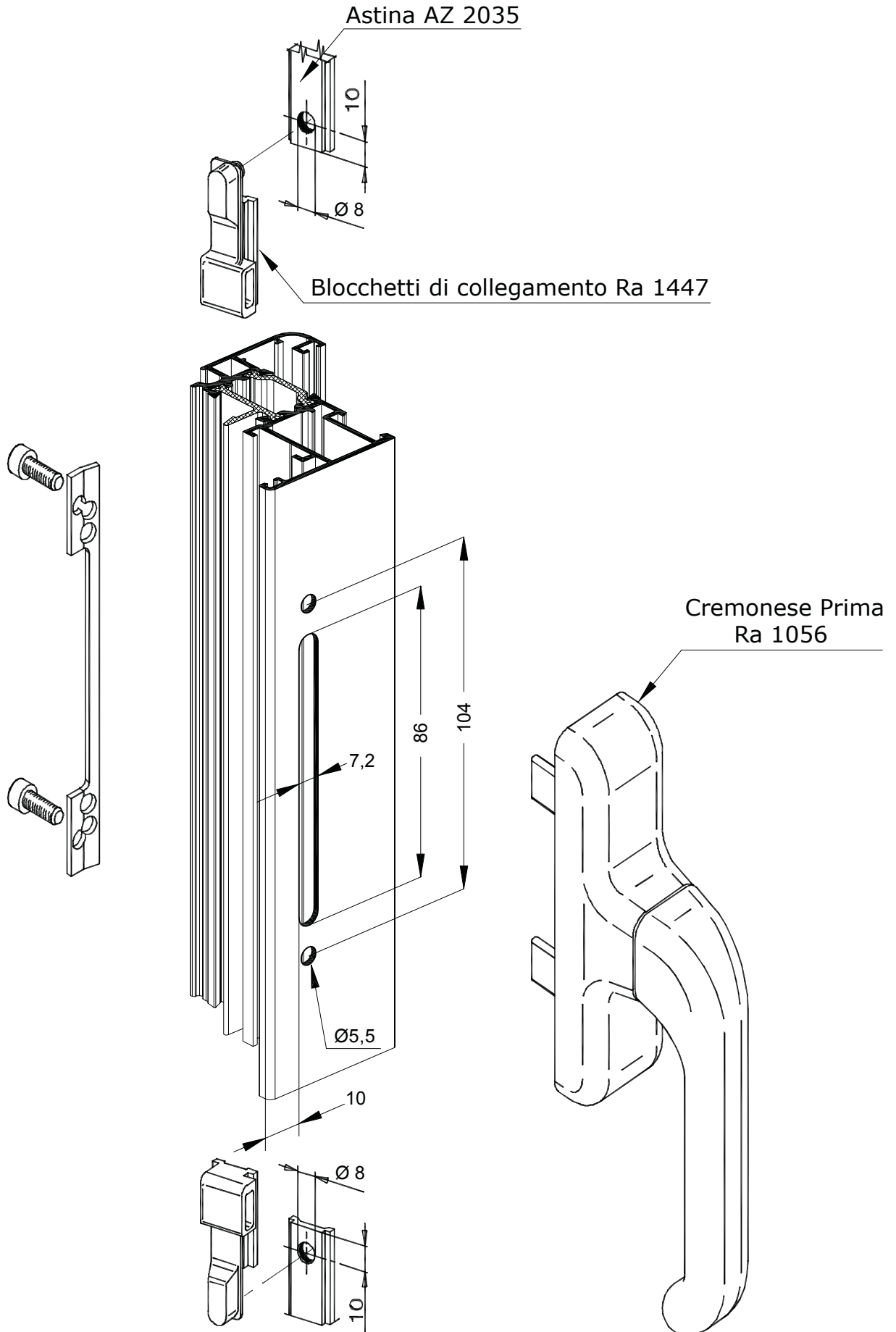

N.B.: - Lavorazione eseguita con punzonatrice Ra 3800



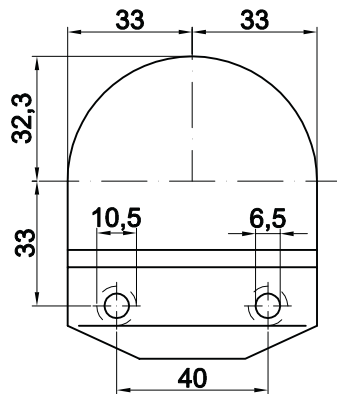
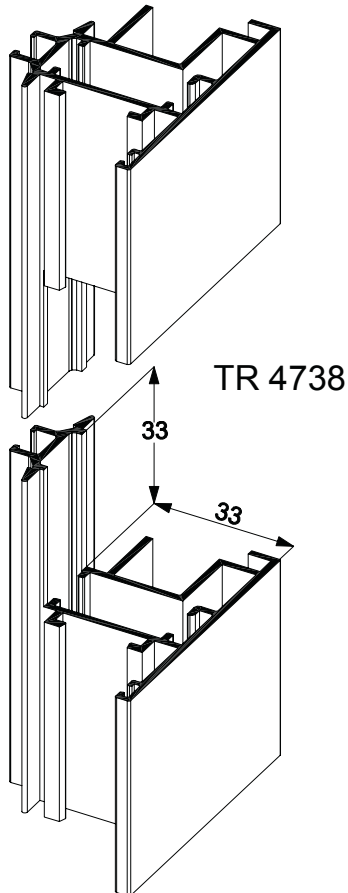
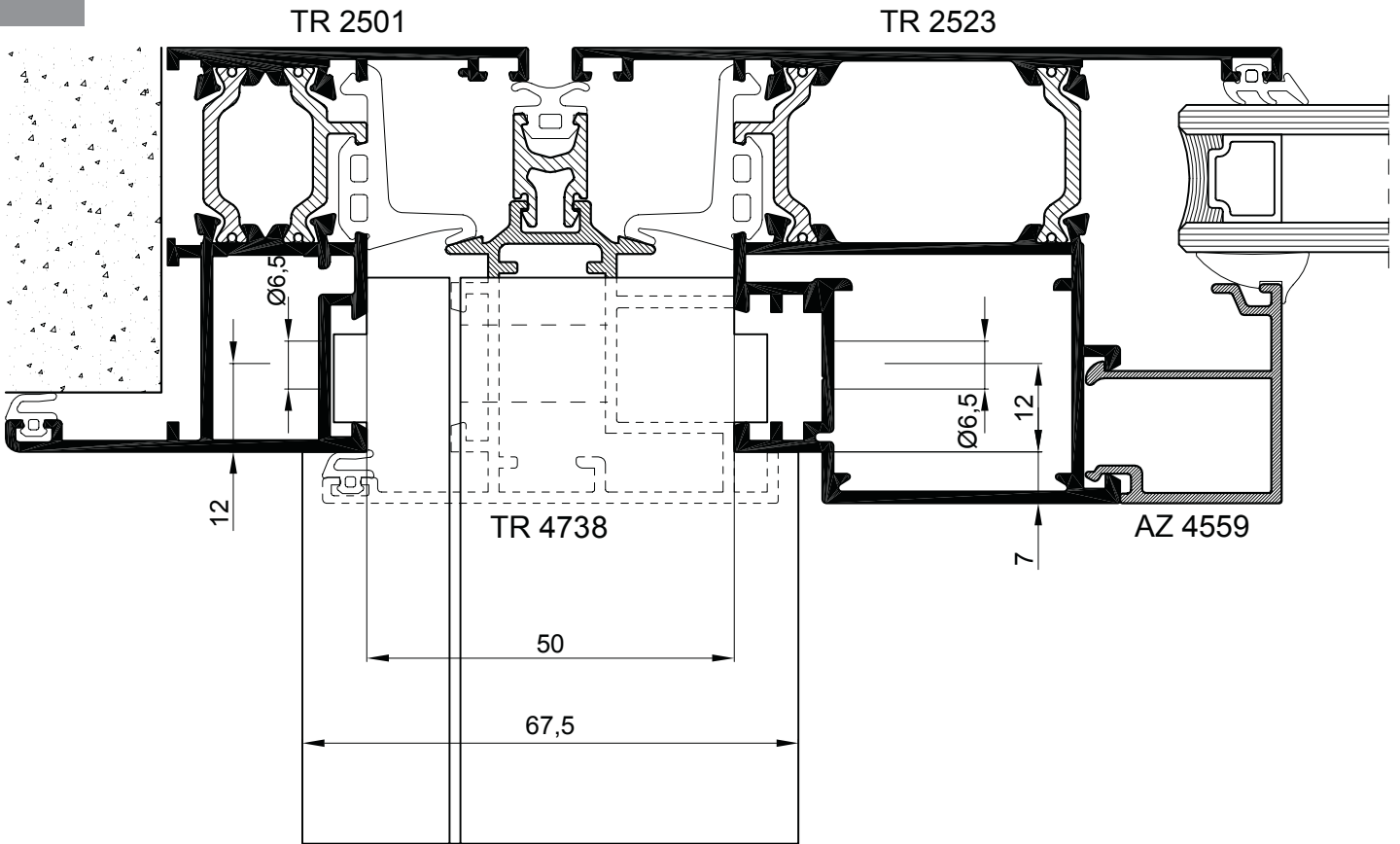

Frizione Ra 1438

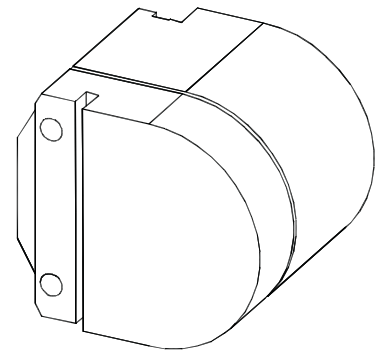



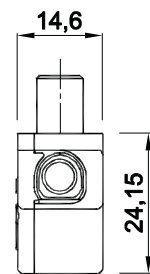
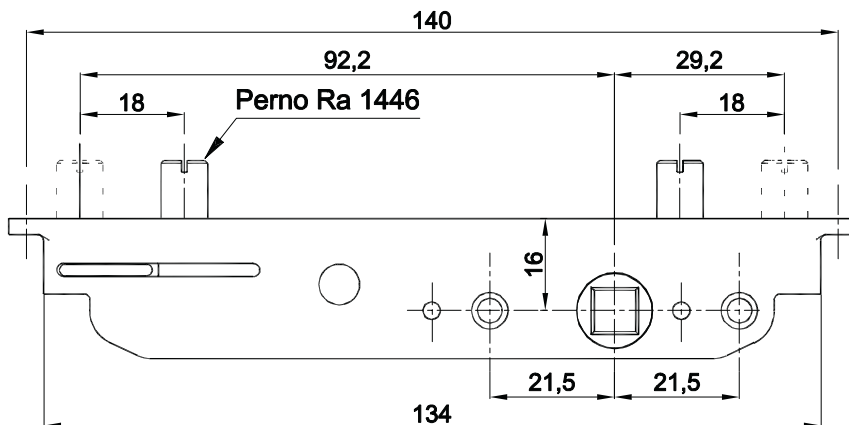
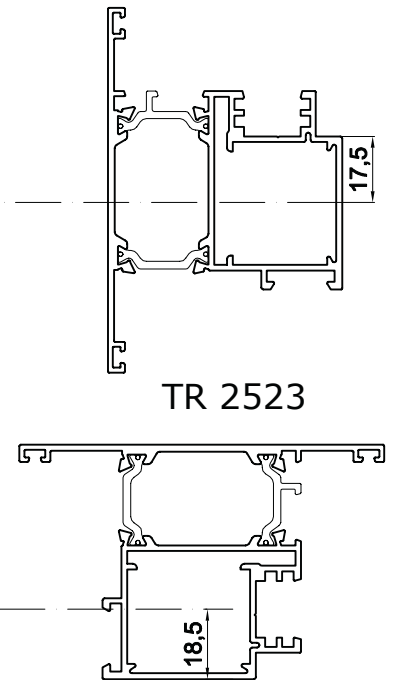
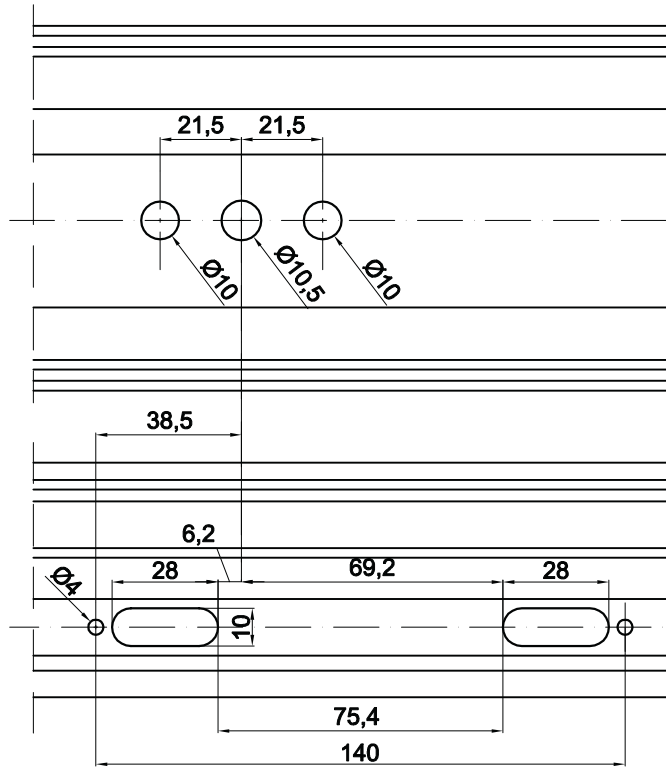
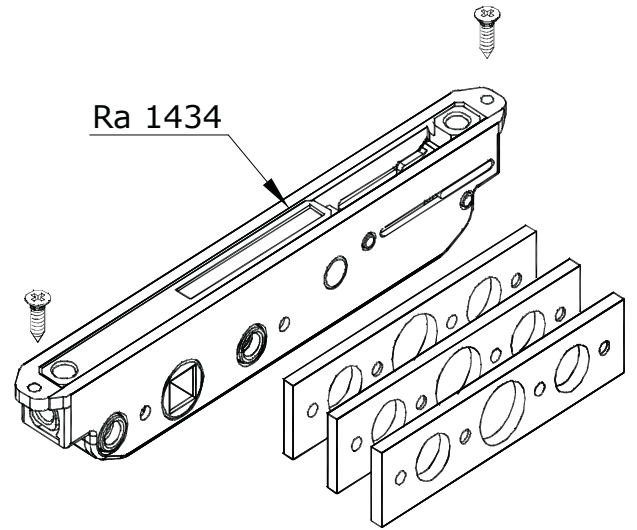
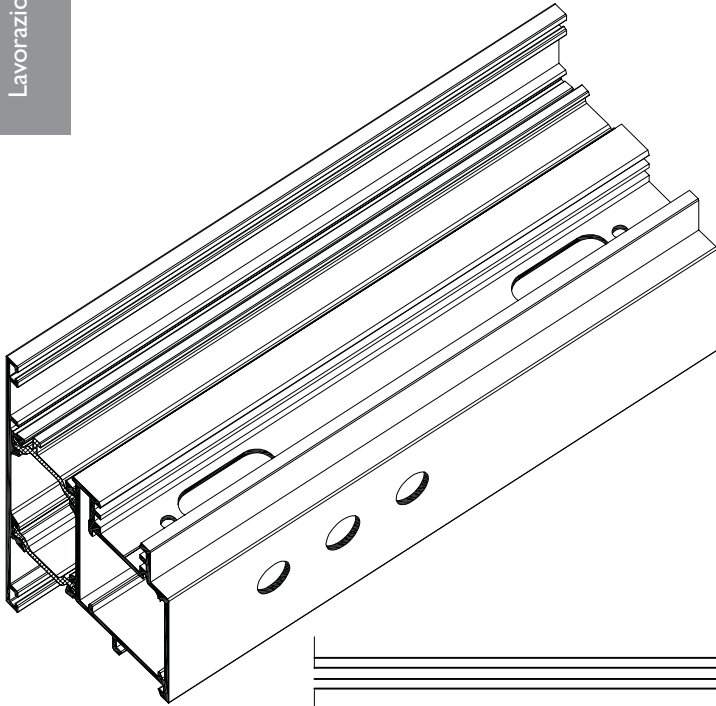

Inserimento movimentazione interna  
bidirezionale per bilico Ra 1434

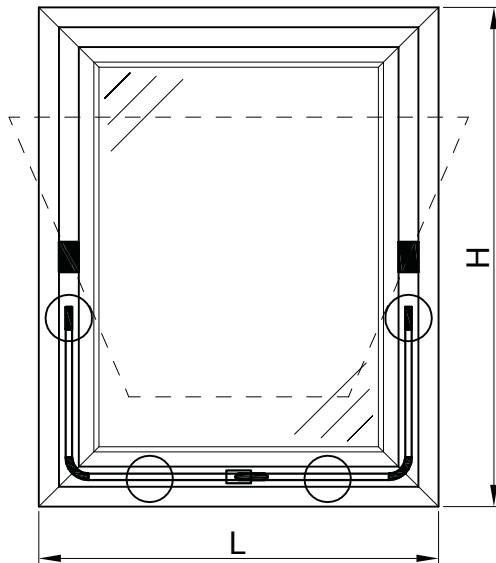
tierre 550TH



**Bilico Verticale**





	Nottolino di chiusura Ra 2918 e incontro Ra 2907	n° 4+4 pz
	Rinvio d'angolo Ra 1453 e perno di collegamento Ra 1446	n° 2+2 pz
	Frizione Ra 1438 *	n° 1 cp
	Martellina Prima Ra 2916 e movimentazione interna Ra 1434	n° 1+1 pz

\* Frizione: peso MAX 75 kg

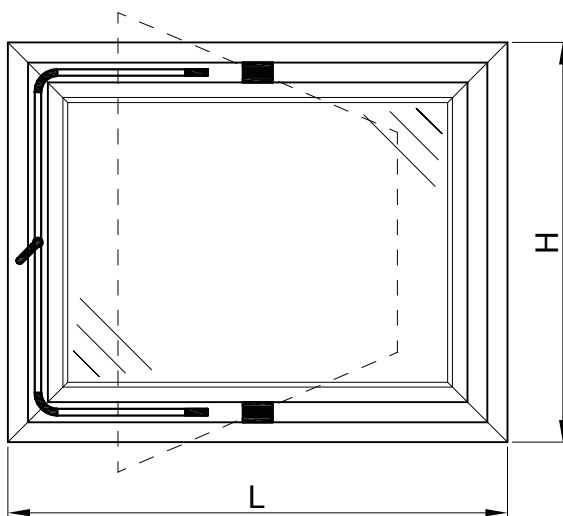
Dimensione MAX: H = 2000 mm  
L = 1500 mm

○ Punti di chiusura

**Bilico Orizzontale**

	Nottolino di chiusura Ra 2918 e incontro Ra 2907	n° 4+4 pz
	Rinvio d'angolo Ra 1453 e blocchetti di collegamento Ra 1447	n° 2+2 pz
	Frizione Ra 1438 *	n° 1 cp
	Cremonese Prima Ra 1056	n° 1+1 pz

\* Frizione: peso MAX 75 kg

Dimensione MAX: H = 2000 mm  
L = 1500 mm

○ Punti di chiusura

N.B.: - Chiusura semplice sia su bilico orizzontale che su bilico verticale mediante tavellini:  
- Maniglia a tavellino Bravo 1 Ra 1439

Gruppo Fresa  
Ra 3815

Materiale da  
asportare

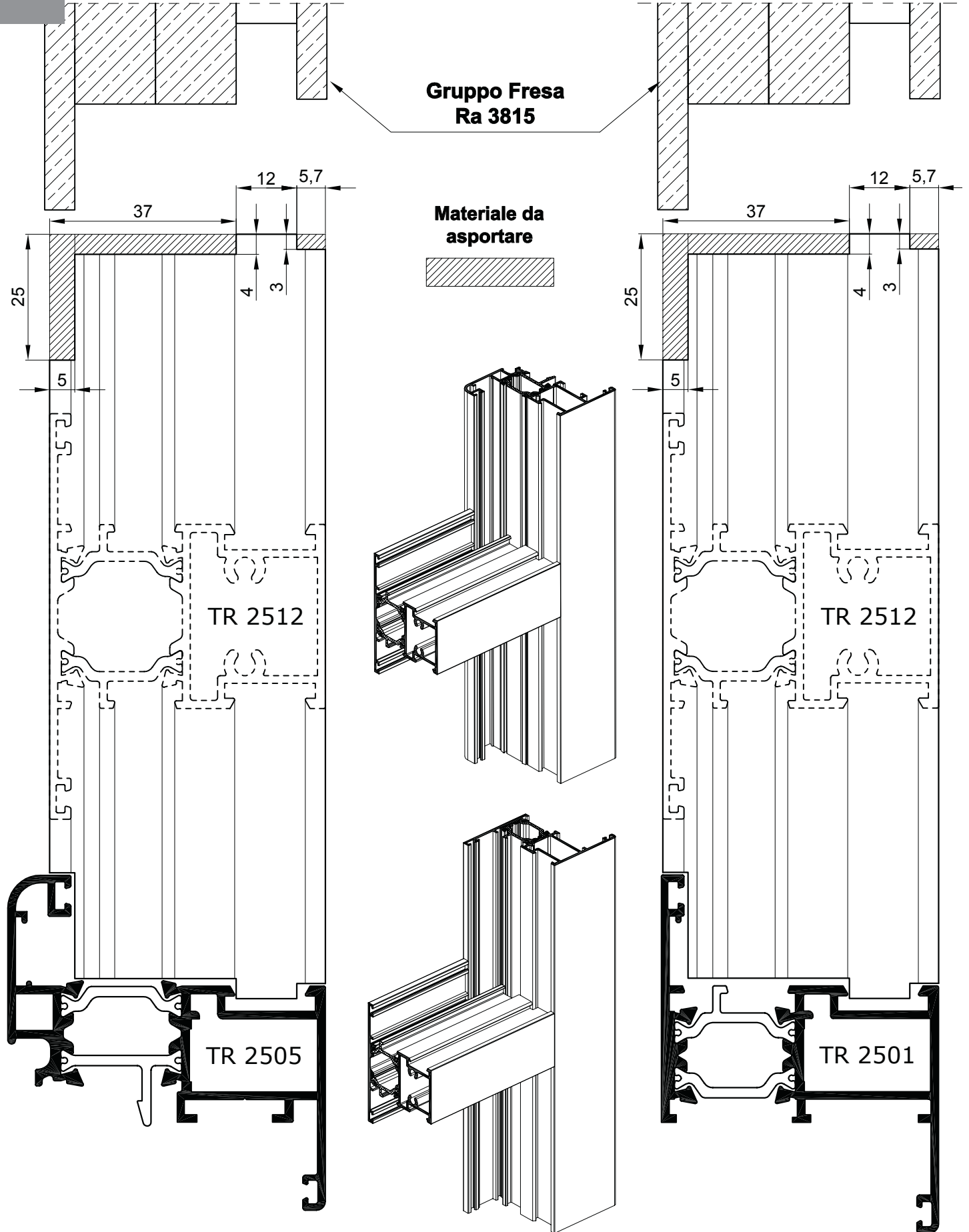

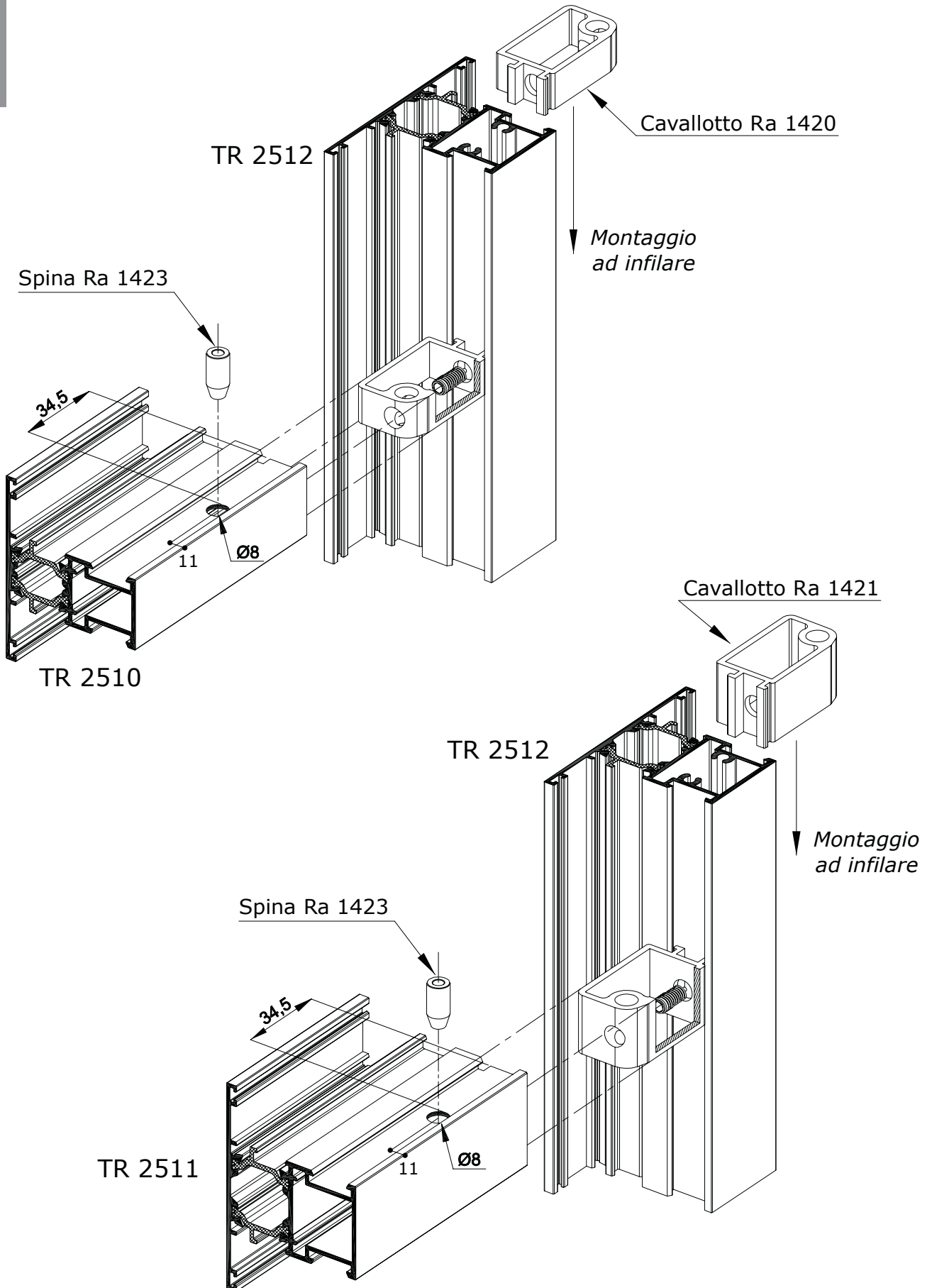

N.B.: - Per l'unione dei traversi si consiglia l'utilizzo del collante  
 - Lavorazione eseguita con gruppo fresa Ra 3815 e con punzonatrice Ra 3800

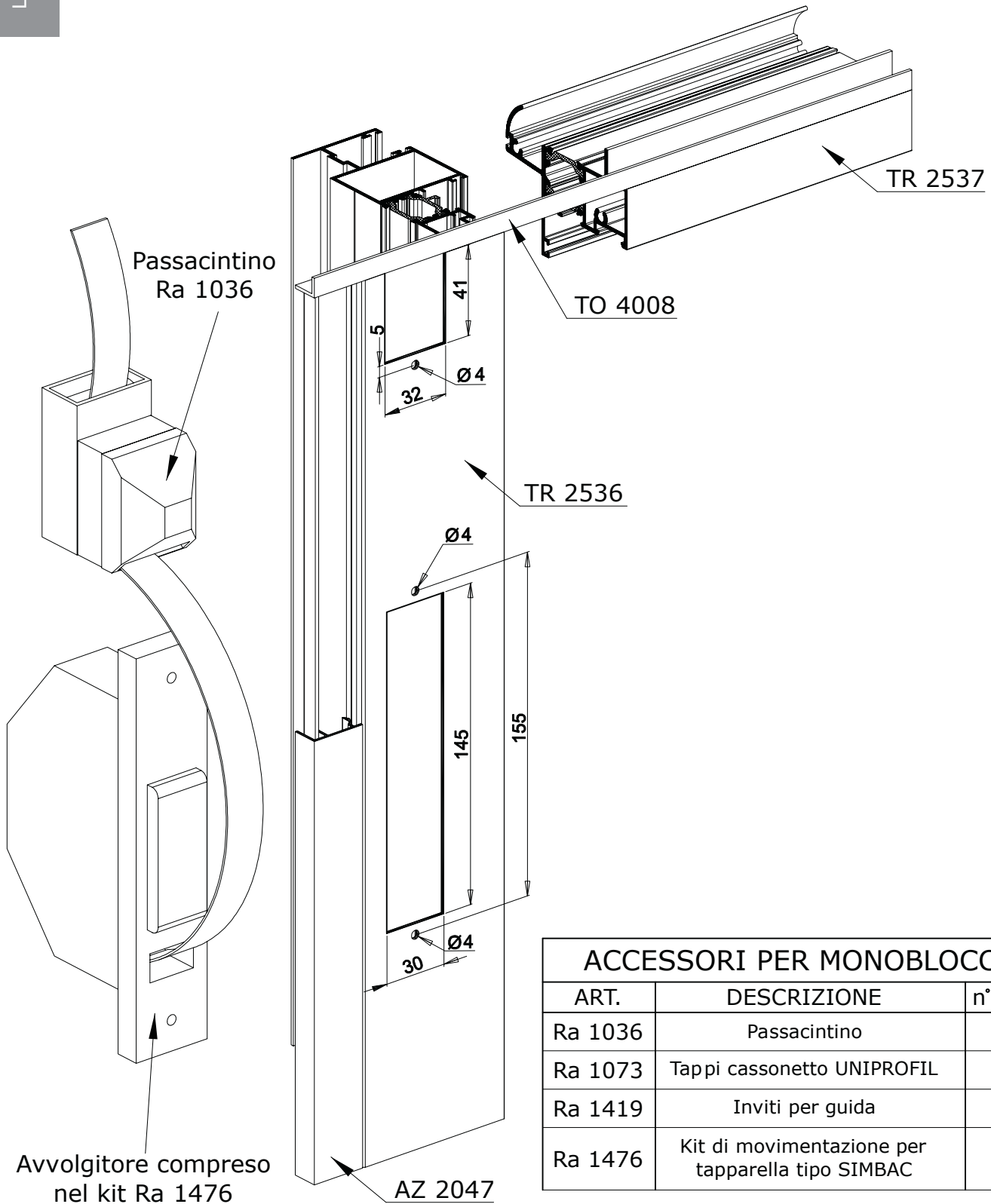

N.B.: IL KIT DI MOVIMENTAZIONE COMPRENDE:

- 1 Avvolgitore
- 1 Puleggia
- 1 Calotta
- 2 Supporti con cuscinetto

La staffa di appoggio cuscinetto va fissata sul controltaio per monoblocco montante

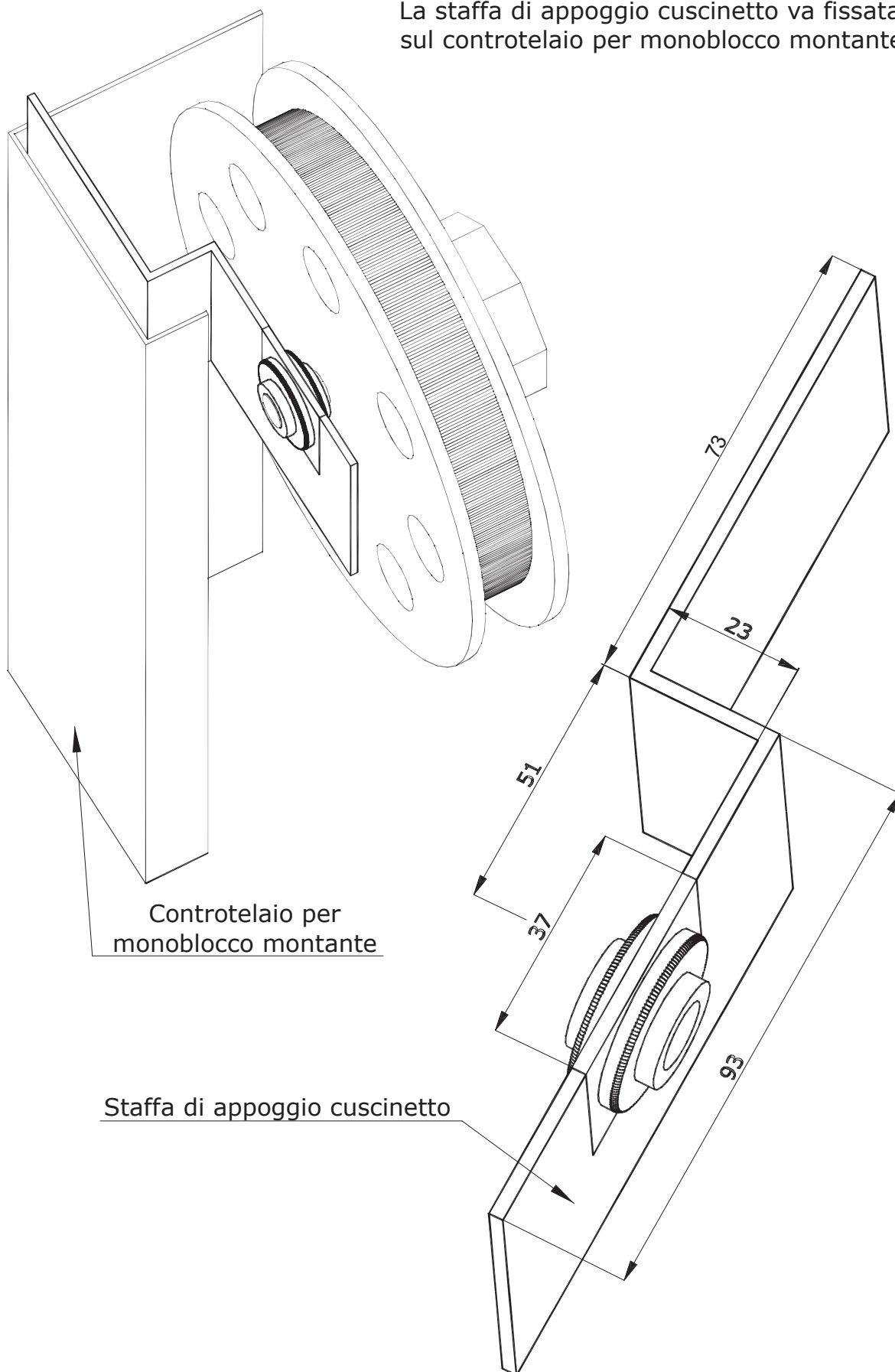

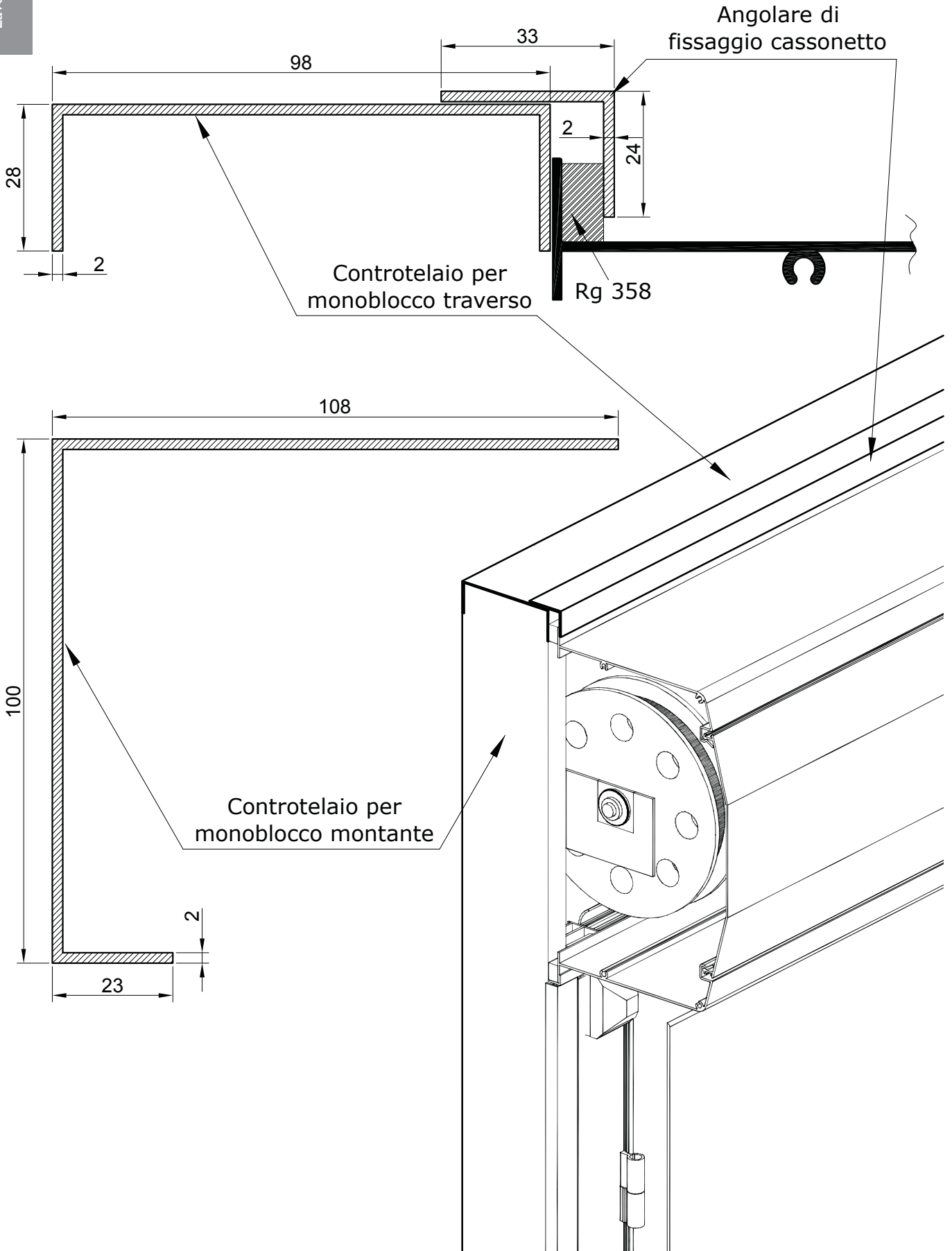



Scala 1:1

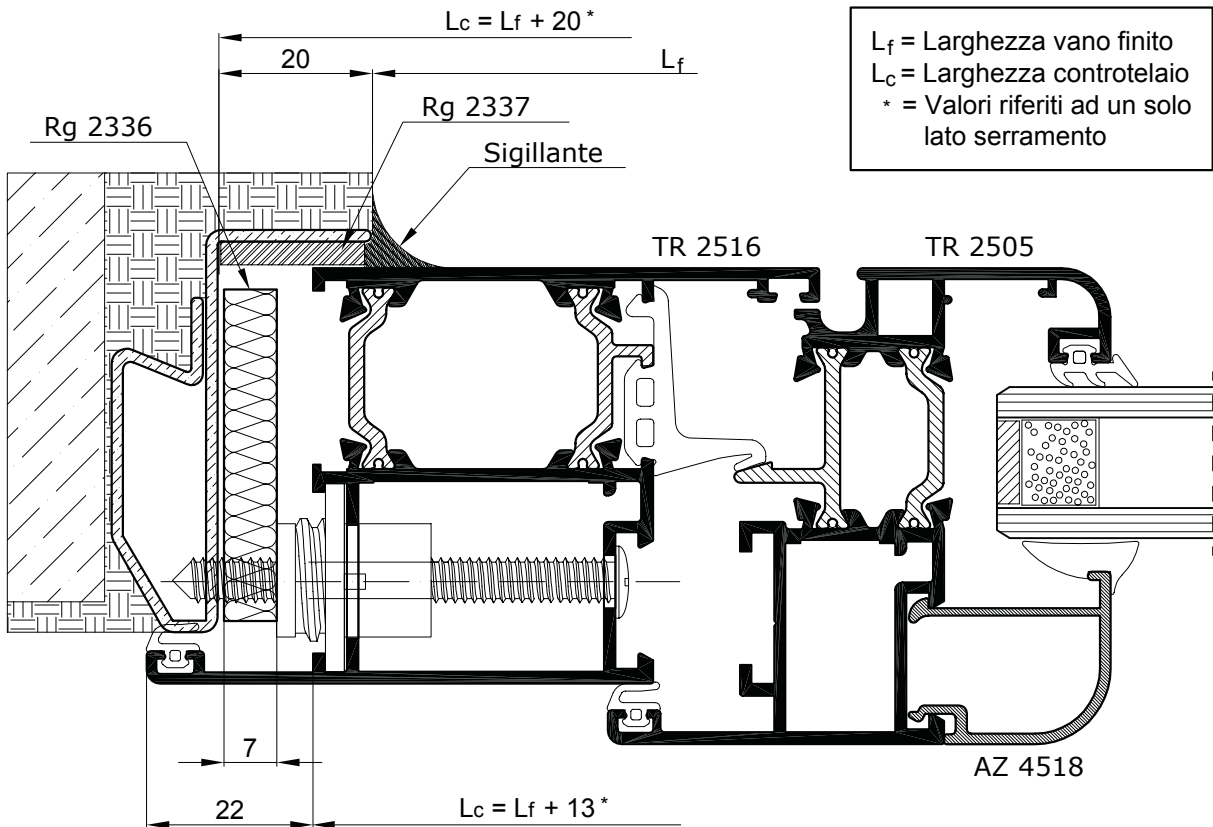
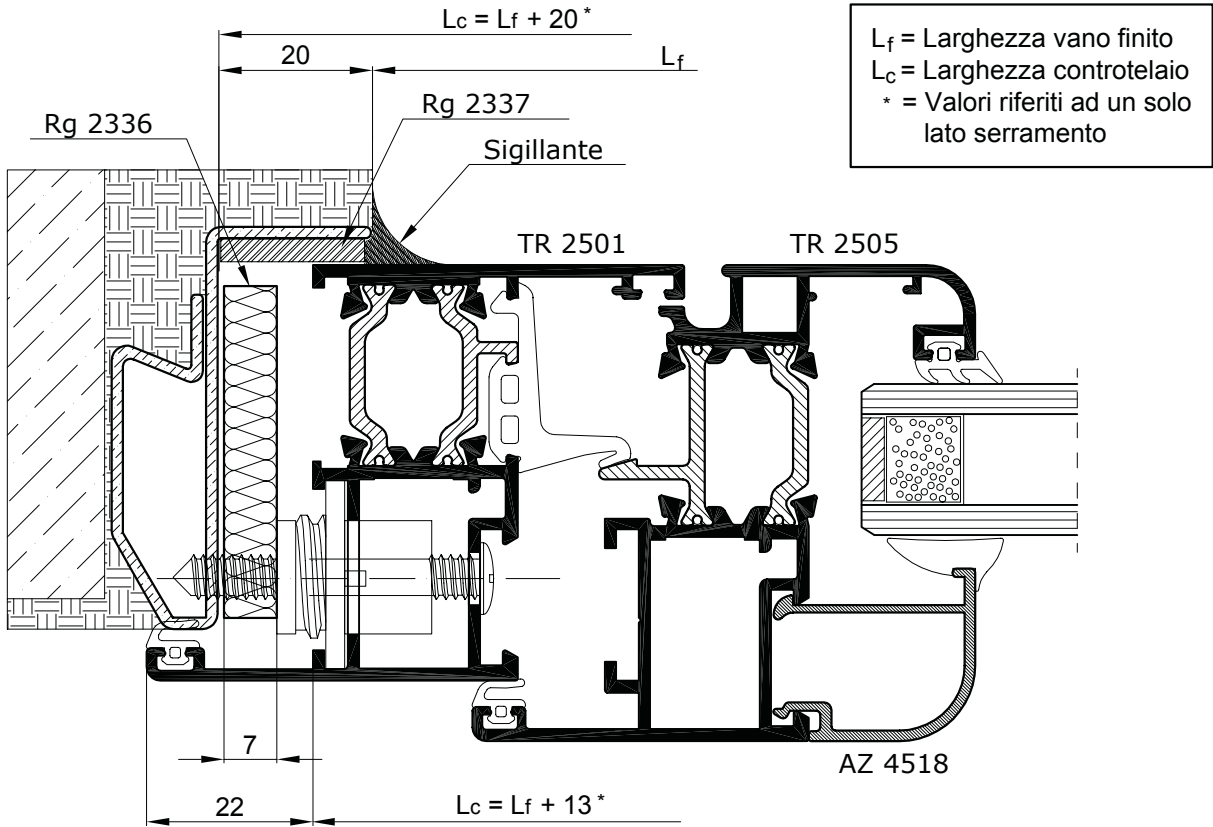

Scala 1:1

$H_f$  = Altezza vano finito  
 $H_c$  = Altezza controtelaio  
 \* = Valori riferiti ad un solo lato serramento  
 = Sigillante

